

## NOTICE OF MAKING

### **HEREFORDSHIRE COUNCIL (U82100 THE OVAL, HEREFORD) (ONE-WAY TRAFFIC) ORDER 2017**

Notice is hereby given that the County of Herefordshire District Council, known as Herefordshire Council, in exercise of its enabling powers has made the above named order under the Road Traffic Regulation Act 1984.

The effect of the Order is to formalise the current direction of travel along The Oval, Hereford between its junctions with Belmont Road Service Road and Goodrich Grove.

A copy of the Order, which comes into operation on 8<sup>th</sup> September 2017 together with the relevant plan, any orders to be revoked and statement of the Council's reasons for making the Order can be viewed on the Council's website at [www.herefordshire.gov.uk](http://www.herefordshire.gov.uk) in the Traffic Regulation Order section. They are also available for inspection during normal office hours at the Council Offices, Plough Lane, Hereford HR4 0LE, (01432 383611) and at the Hereford Centre, Franklin House, 4 Commercial Road, Hereford, HR1 2BB, (01432 260500). Photocopies of the same may be provided on payment of photocopying charges at the Council. General enquiries relating to the proposal should be referred to the Traffic Management Team at ADL Traffic Engineering Ltd (Tel: 01454 332100).

If any person wishes to question the validity of the Order or of any of its provisions on the grounds that it or they are not within the powers conferred by the Act, or that any requirement of the Act or of any instrument made under the Act has not been complied with that person may, within six weeks from the date the order is made, apply for the purpose to the High Court.

Richard Ball  
Assistant Director Environment and Place

**THE ROAD TRAFFIC REGULATION ACT 1984**

**HEREFORDSHIRE COUNCIL (U82100 THE OVAL, HEREFORD)  
(ONE-WAY TRAFFIC) ORDER 2017**

The County of Herefordshire District Council, ("the Council"), in exercise of its powers under section 1, 2, and 3, and Part IV of Schedule 9 of the Road Traffic Regulation Act of 1984 (referred to as "the Act") and of all other enabling powers and after consultation with the Chief Officer of Police in accordance with part III of schedule 9 to the Act hereby makes the following Order:

1. The Order shall come into operation on 8<sup>th</sup> September 2017 and may be cited as "Herefordshire Council (U82100 The Oval, Hereford) (One-Way Traffic) Order 2017".
2. Interpretation:  
In this Order –  
'Motor vehicle' shall have the meaning as assigned to it in Section 136 of "the Act of 1984".  
'Pedal Cycle' shall have the meaning as assigned to it in Schedule 1 of The Traffic Signs Regulations and General Directions 2016.
3. No person shall cause or permit any motor vehicle or pedal cycle to proceed along the length of the U82100 The Oval, Hereford between its junction with Goodrich Grove and a point 236.5 metres north-east of the junction with Goodrich Grove and which for identification purposes only is shown on the attached plan in any direction other than north-east to south-west.
4. Nothing in Article 3 of this Order applies to:  
(a) A vehicle being used for fire and rescue, ambulance or police purposes  
  
(b) Anything done with the permission of or at the direction of a Police Constable in uniform
5. The County of Hereford and Worcester (Belmont Road Service Road, Hereford) (One- Way, Traffic) Order 1979 is hereby revoked.
6. References to any statutory provision herein shall include reference to any statutory modification substitution or re-enactment thereof.

Dated this 11th Day of August 2017

**THE COMMON SEAL** of the  
**COUNTY OF HEREFORDSHIRE**  
**DISTRICT COUNCIL**  
was hereunto affixed **BY ORDER**

Authorised Officer... *Kate Coghlan* .....





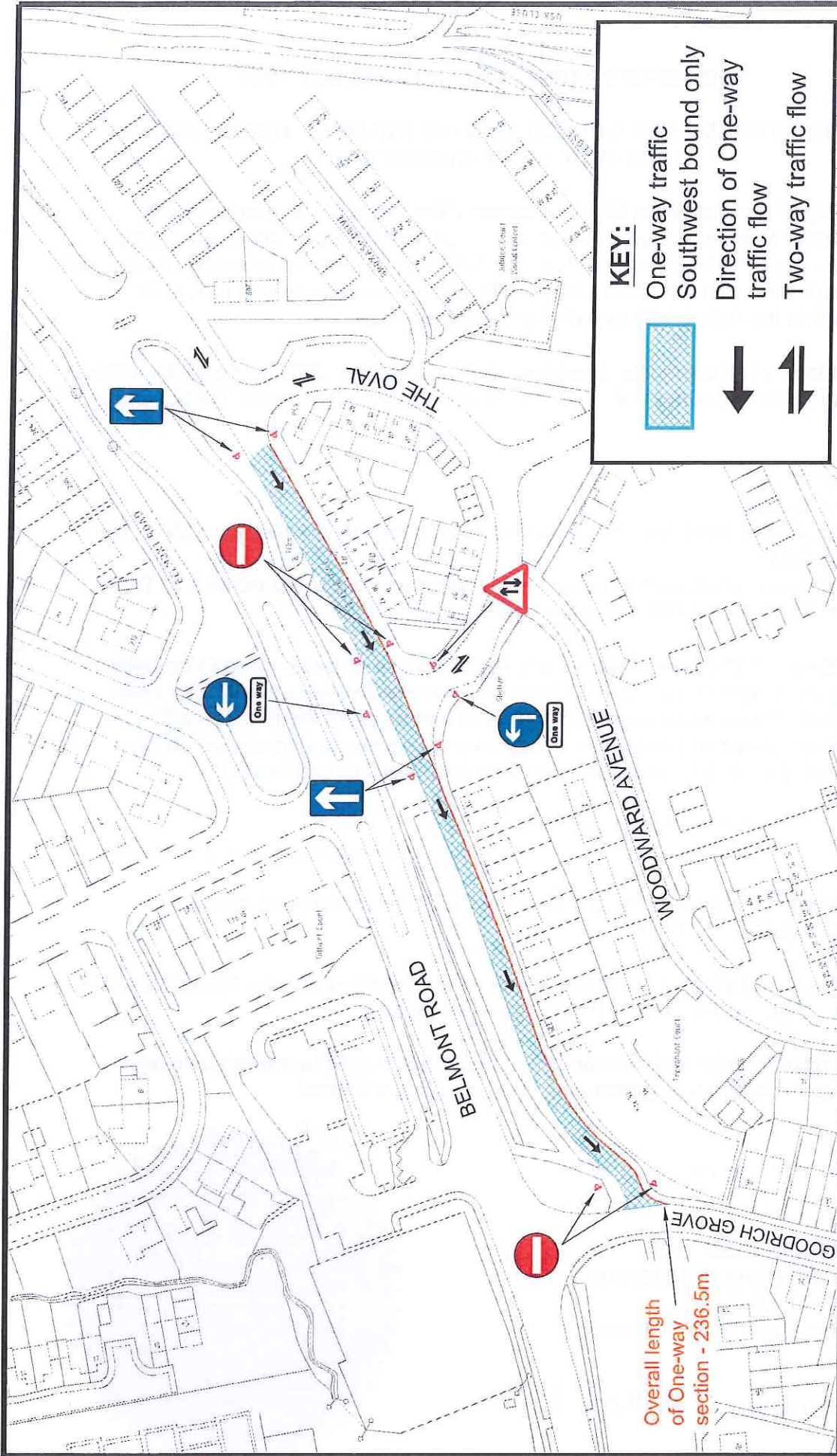

**KEY:**

- One-way traffic
- Southwest bound only
- Direction of One-way traffic flow
- Two-way traffic flow

Overall length of One-way section - 236.5m

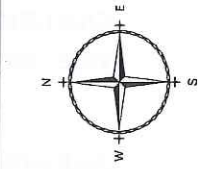

**ADL**  
TRAFFIC

ADL Traffic Engineering Ltd.  
The Oaklands Business Park  
Yate, Bristol  
GL8 5NA  
Tel : 01454 327100  
Fax : 01454 327093  
E-Mail : CAD@ADLTRAFFIC.CO.UK

- NOTES**
1. PRELIMINARY DESIGN PROVIDED FOR ILLUSTRATIVE PURPOSES ONLY. ALL DETAILS ARE SUBJECT TO INCLUDING CHECKING STATUTORY SERVICE APPARATUS.
  2. DO NOT SCALE FROM THIS DRAWING.
  3. BACKGROUND PLAN IS BASED UPON OSBASE.
  4. ALL DETAILS TO BE CONFIRMED ON SITE AND ON A VISUAL SURVEY.
  5. ALL TRACKS ASSUME GRADIENTS AND CARRIAGES DO NOT EXCEED 180 AND 140 RESPECTIVELY OTHERWISE VEHICLE MANOEUVRABILITY MAY BE AFFECTED.
  6. ALL LAND OWNERSHIP DETAILS, EXTENT OF ADOPTED HIGHWAY AND RIGHTS OF WAY TO BE CONFIRMED.
  7. ASSUMES ALL LANDSCAPING CAN BE ALTERED AND NO TREES ARE SUBJECT TO TPO.
- © Copyright ADL Traffic Engineering Ltd

AMENDMENT	REF.	DATE	DESCRIPTION
A	21/09/16		DIMENSION ADDED.
B	20/02/17		PLAN REVISED.
C	10/02/17		PLAN UPDATED.

ADL Job No. 3409

Project: The Oval, Herefordshire

Title: THE OVAL TPO drawing

Date: 07.12.2016  
Drawn: MT

Checked: [ ]  
Date: [ ]  
Approved: [ ]  
Date: [ ]

Scale: 1:1000  
Orig. No.: 3409-01  
Rev.: C

## HEREFORDSHIRE COUNCIL

### STATEMENT OF REASONS FOR MAKING

#### **HEREFORDSHIRE COUNCIL (U82100 THE OVAL, HEREFORD) (ONE-WAY TRAFFIC) ORDER 2017**

Herefordshire Council is formalising the existing one-way traffic system in The Oval, Hereford between its junctions with Belmont Road Service Road and Goodrich Grove by the process of the above named Traffic Regulation Order. The Order will have no physical effect on the already operational one-way system as indicated by current arrangements and signage.

The Order is being made for the following reasons:

- To clarify the existing one-way restriction in accordance with current standards and formats, and to comply with current enforcement policy,
- For avoiding danger to persons or other traffic using the road or any other road or for preventing the likelihood of any such danger arising,
- For facilitating the passage on the road or any other road of any class of traffic (including pedestrians) (*i.e. to maintain access and/or to reduce congestion*),
- For preserving or improving the amenity of the area through which the road runs,

The Order been subject to consultation with the public, local Councillors representing the area, the local Police, Ambulance, Fire and Rescue Services and Herefordshire County Council Passenger Transport Unit.

Richard Ball  
Assistant Director Environment and Place



our file

583

ROAD TRAFFIC REGULATION ACT 1967

THE COUNTY OF HEREFORD AND WORCESTER

(BELMONT ROAD SERVICE ROAD, HEREFORD)

(ONE-WAY TRAFFIC) ORDER. 1979

The County Council of Hereford and Worcester, in exercise of their powers under Section 1(1), (2) and (3) of the Road Traffic Regulation Act, 1967, as amended by Part IX of the Transport Act, 1968, Schedule 19 of the Local Government Act 1972 and Schedule 6 to the Road Traffic Act, 1974 (which said Act of 1967 as so amended is hereinafter referred to as "the Act of 1967"), and of all other powers them enabling in that behalf, and after consultation with the Chief Officer of Police in accordance with Section 84C(1) of the said Act of 1967, hereby make the following Order:-

1. No person shall cause any vehicle to proceed in that part of Belmont Road Service Road in the City of Hereford in the County of Hereford and Worcester from its junction with the Oval to its junction with Goodrich Grove in a direction other than from north-east to south-west.
2. This Order shall come into operation of the 19th day of February, 1979 and may be cited as the County of Hereford and Worcester (Belmont Road Service Road, Hereford) (One-Way Traffic) Order 1979.
3. The City of Hereford (Access Road to the Oval) (One-Way) Order 1964 is hereby revoked.

Dated this 26th day of January, 1979.

The Common Seal of the )  
County Council of Hereford )  
and Worcester was affixed )  
hereto in the presence of: )

L.S.

County Secretary and Solicitor