

2.9 Local Distributor Roads

- Design speed 30mph
- Road Width 7.3m
- Minimum centre line radius 40m
- Forward visibility 60m
- Individual Private access only in exceptional circumstances
- Minimum of two access to existing highway network
- Visibility in accordance with section 2.12

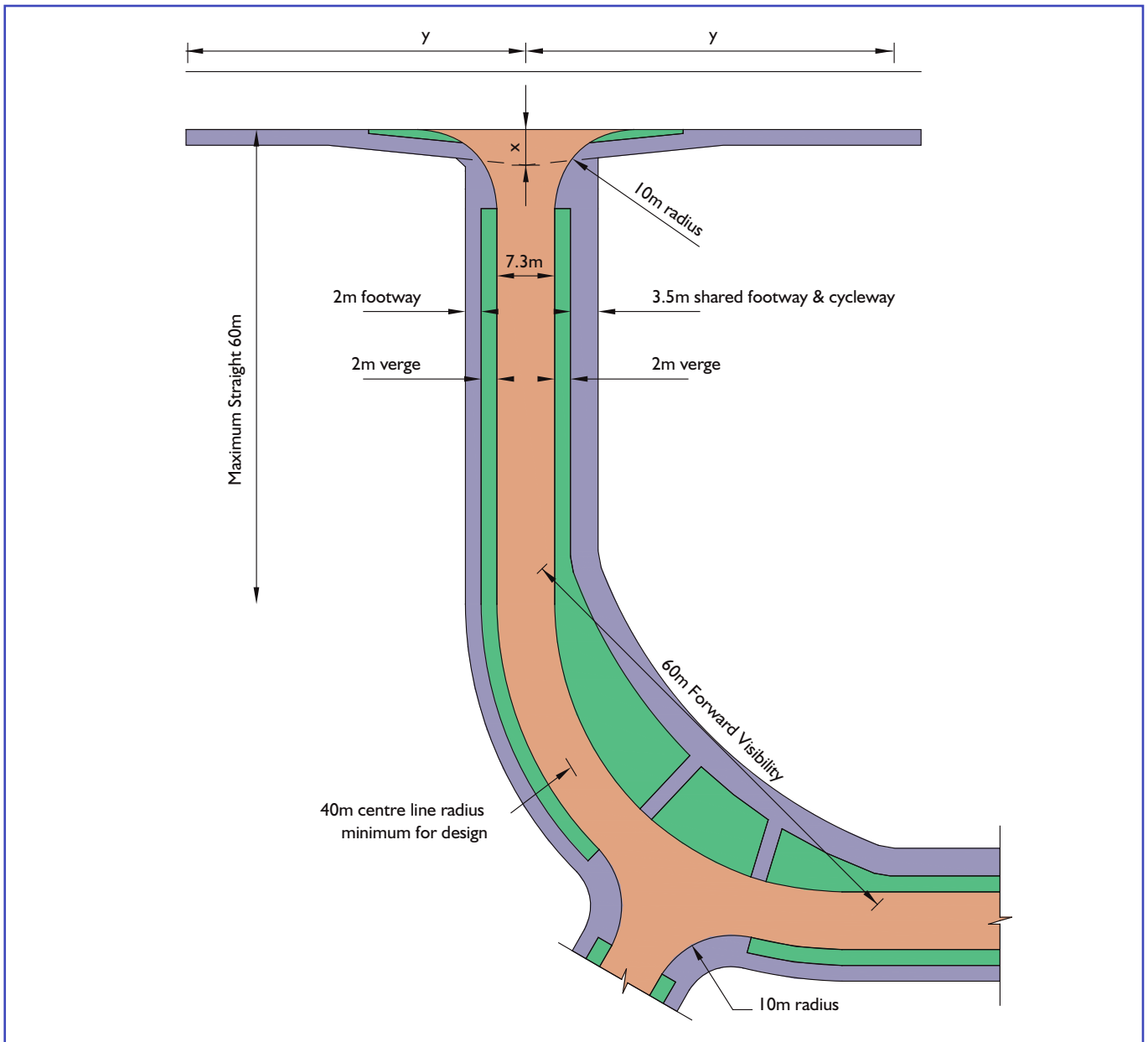

Entry Radii

With higher category of road	Designed in accordance with HA TD 42/95 but not less than 10m
-------------------------------------	---

Junction Spacing

Same side	100m
Opposite side	50m