

Latham, James

From: Kitto, Stephanie
Sent: 19 November 2019 14:43
To: Latham, James
Subject: FW: Titley Examiners Questions
Attachments: P160581O - Site Location Plan - Approved.pdf; P162824O - Site Location Plan - Refusal.pdf

Herefordshire.gov.uk

Stephanie Kitto AssocRTPI
Neighbourhood Planning Officer
Neighbourhood Planning Team
Herefordshire Council
Plough Lane
Hereford
HR4 0LE

Tel: 01432 260411

email: stephanie.kitto@herefordshire.gov.uk
www.herefordshire.gov.uk/neighbourhoodplanning

Any opinion expressed in this e-mail or any attached files are those of the individual and not necessarily those of Herefordshire Council.

This e-mail and any attached files are confidential and intended solely for the use of the addressee. This communication may contain material protected by law from being passed on. If you are not the intended recipient and have received this e-mail in error, you are advised that any use, dissemination, forwarding, printing or copying of this e-mail is strictly prohibited. If you have received this e-mail in error please contact the sender immediately and destroy all copies of it.

From: Kitto, Stephanie
Sent: 15 November 2019 14:43
To: 'Ann Skippers' <ann@annskippers.co.uk>
Subject: FW: Titley Examiners Questions

Hi Ann,

I have been in touch with a Development Officer who has been able to give some more background on the site.

This site has a rather lengthy and complicated planning history. The key points however are summarised below;

There is an extant outline permission at Balance Farm for five four bedroom dwellings under reference P160381/O. I attach the site location plan for reference. Reserved matters approval in respect of access was granted on appeal

under reference 181476/RM, and we currently have a valid application for the remaining reserved matters under reference P192515/RM.

The applicant also applied for 5 houses on an adjoining site in under reference P162824/O. Again I include a site plan for reference. A non-determination appeal in respect of this application was however dismissed on highways safety grounds.

Hope this clarifies. If you need anything else, please let me know.

Kind regards
Stephanie

Herefordshire.gov.uk

Stephanie Kitto AssocRTPI
Neighbourhood Planning Officer
Neighbourhood Planning Team
Herefordshire Council
Plough Lane
Hereford
HR4 0LE

Tel: 01432 260411

email: stephanie.kitto@herefordshire.gov.uk
www.herefordshire.gov.uk/neighbourhoodplanning

Any opinion expressed in this e-mail or any attached files are those of the individual and not necessarily those of Herefordshire Council.

This e-mail and any attached files are confidential and intended solely for the use of the addressee. This communication may contain material protected by law from being passed on. If you are not the intended recipient and have received this e-mail in error, you are advised that any use, dissemination, forwarding, printing or copying of this e-mail is strictly prohibited. If you have received this e-mail in error please contact the sender immediately and destroy all copies of it.

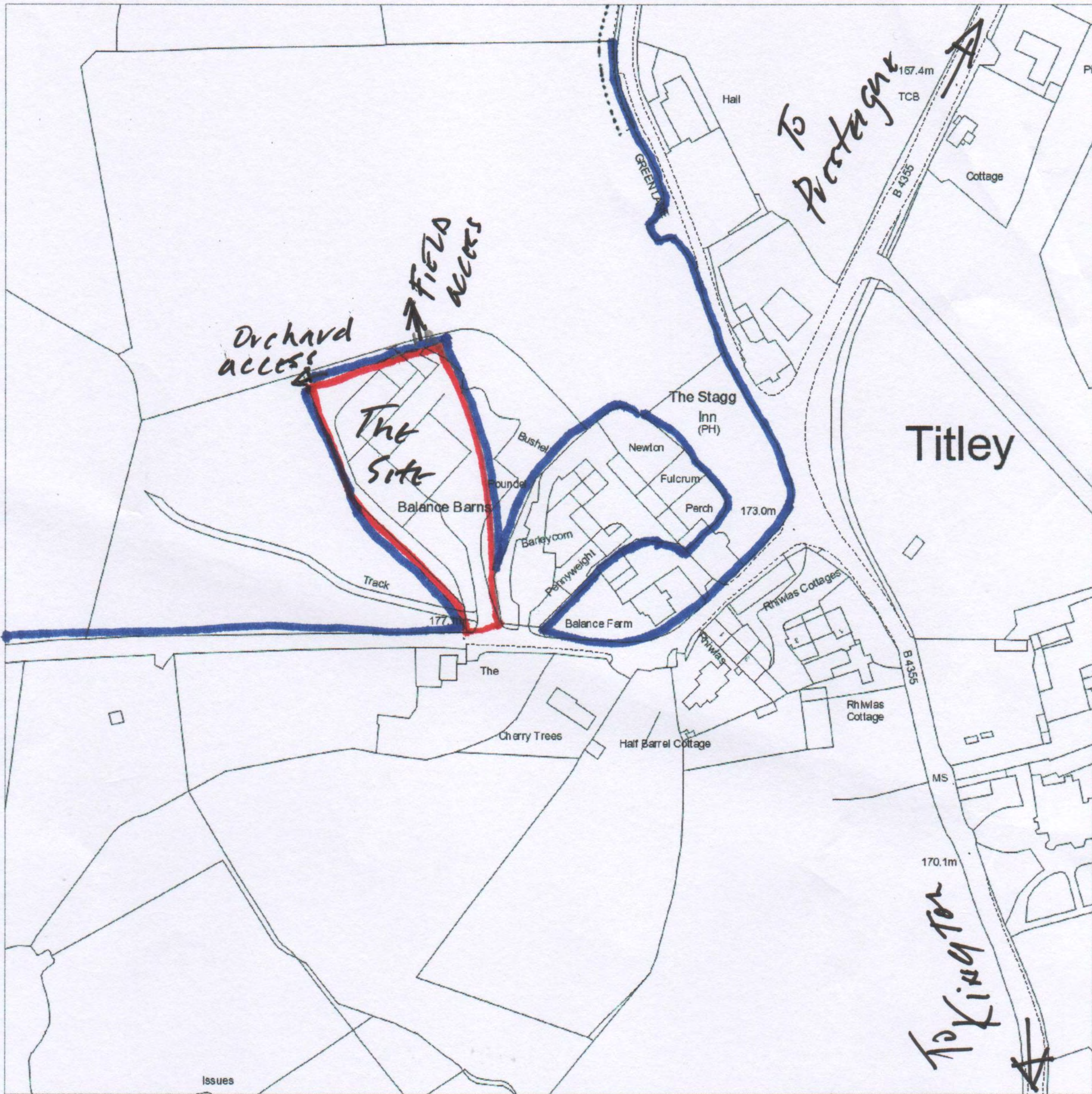

Balance Farm, Titley, Kington

Scale 1:2500

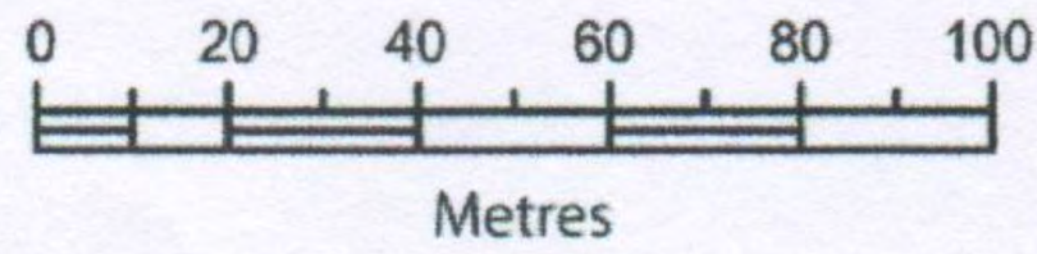

Reproduction in whole or in part is prohibited without the prior permission of Ordnance Survey.

Ordnance Survey and the OS Symbol are registered trademarks and OS MasterMap® is a trademark of Ordnance Survey, the national mapping agency of Great Britain.

The representation of a road, track or path is no evidence of a right of way.

The representation of features as lines is no evidence of a property boundary.

Date Of Issue: 13 August 2015
Supplied By: Getmapping
Supplier Plan Id: 148106_2500
OS License Number: 100030848
Applicant: Mrs A Vaughan
Application Reference: Land at Balance Farm Titley.

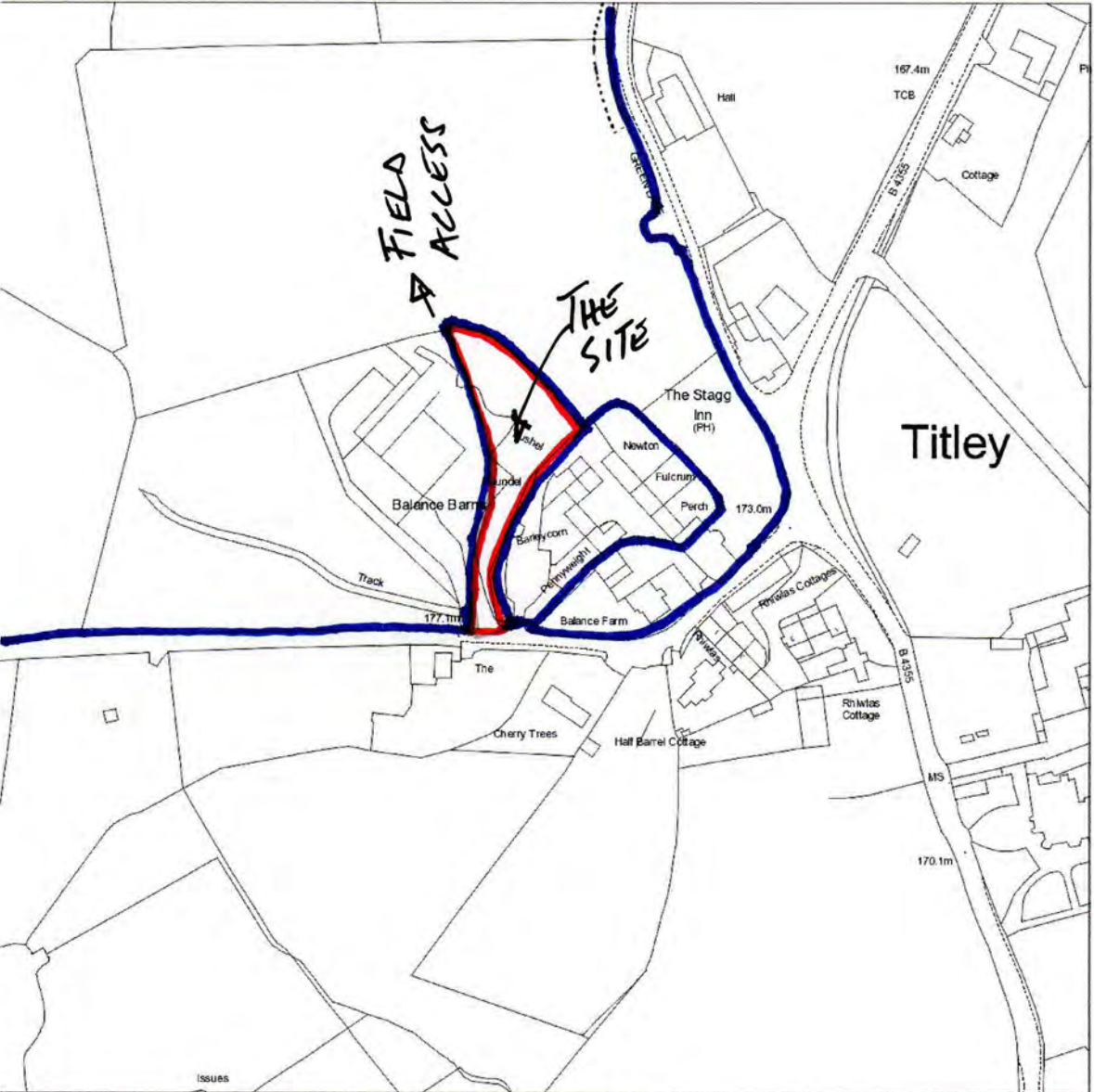

Balance Farm, Titley, Kingon

Scale 1:2500

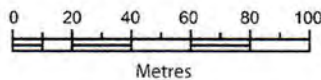

Reproduction in whole or in part is prohibited without the prior permission of Ordnance Survey. Ordnance Survey and the OS Symbol are registered trademarks and OS MasterMap® is a trademark of Ordnance Survey, the national mapping agency of Great Britain.

Date Of Issue: 13 August 2015
Supplied By: Getmapping
Supplier Plan Id: 148106_2500
OS License Number: 100030848
Applicant: Alan Poole
Application Reference: Land at Balance Farm Titley.

The representation of a road, track or path is no evidence of a right of way. The representation of features as lines is no evidence of a property boundary.