

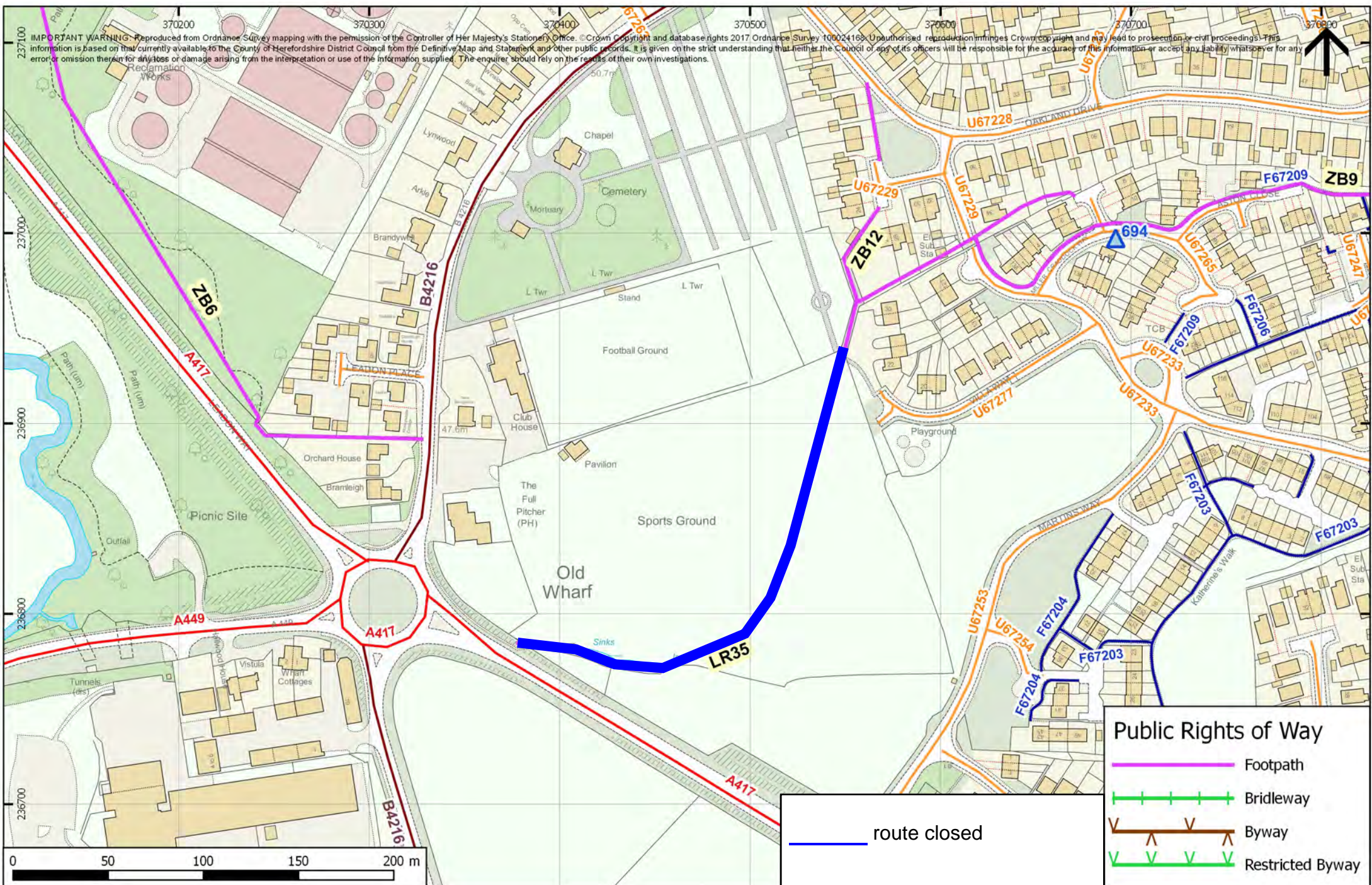





IMPORTANT WARNING - Reproduced from Ordnance Survey mapping with the permission of the Controller of Her Majesty's Stationery Office. © Crown Copyright and database rights 2017 Ordnance Survey 100024168. Unauthorised reproduction infringes Crown copyright and may lead to prosecution or civil proceedings. This information is based on that currently available to the County of Herefordshire District Council from the Definitive Map and Statement and other public records. It is given on the strict understanding that neither the Council nor any of its officers will be responsible for the accuracy of this information or accept any liability whatsoever for any error or omission therein for any loss or damage arising from the interpretation or use of the information supplied. The enquirer should rely on the results of their own investigations.



Public Rights of Way

-  Footpath
-  Bridleway
-  Byway
-  Restricted Byway

 route closed

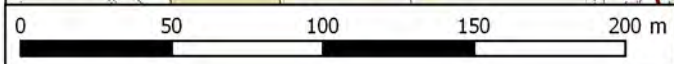

Temporary Closure Public Footpath LR35

SCALE: 1:2,500
 DATE: 14/09/2021
 PROJECT

Balfour Beatty Living Places
 Unit 3 Thorn Business Park
 Rotherwas
 Hereford HR2 6JT

Balfour Beatty 
 Working for Herefordshire