

NOTICE OF PROPOSAL

Herefordshire Council hereby gives notice that in exercise of its statutory enabling powers it is proposing to make **THE COUNTY OF HEREFORDSHIRE DISTRICT COUNCIL (ST OWEN STREET CYCLE SCHEME, HEREFORD) (WAITING AND PARKING) ORDER 2022**, the effect of which will be:

A. To introduce and restate restrictions (where there is no change) on the *south-west* side of **St Peter's Square** as described in the table below:

Restriction	Extent
1) No waiting at any time & No loading at any time	From the south-eastern kerblines of Offa Street south-eastwards for 20m
2) Loading only, Monday-Saturday: 6am-6pm (max stay: 30mins, no return: 1hr)	From 20m south-east of the south-eastern kerblines of Offa Street south-eastwards for 16.5m
3) No waiting at any time and No loading at any time	From 36.5m south-east of the south-eastern kerblines of Offa Street south-eastwards for 2.5m
4) Disabled badge holders only (max stay: 2hrs, no return: 2hrs)	From 36.5m south-east of the south-eastern kerblines of Offa Street south-eastwards to its junction with St Owen Street (continues in St Owen Street)

B. To introduce and restate (where there is no change) restrictions on the *south-west* side of **St Owen Street** (also known as *St Owen's Street*) as described in the table below:

Restriction	Extent
5) Disabled badge holders only (max stay: 2hrs, no return: 2hrs)	From its junction with St Peter's Square south-eastwards for 11.5m (continued from St Peter's Square)
6) No waiting at any time & No loading at any time	From 11.5m south-east of its junction with St Peter's Square south-eastwards for 2m
7) Informal crossing (noted for information only)	From 13.5m south-east of its junction with St Peter's Square south-eastwards for 10m
8) No waiting at any time and No loading at any time	From 23.5m south-east of its junction with St Peter's Square south-eastwards for 22.5m
9) Pay & Display, Monday - Saturday: 8am - 6pm (max stay: 2 hrs, no return: 2hrs)	From 46m south-east of its junction with St Peter's Square south-eastwards for 76.5m
10) Informal crossing (noted for information only)	From 122.5m south-east of its junction with St Peter's Square south-eastwards for 10m
11) Pay & Display, Monday - Saturday: 8am - 6pm (max stay: 2 hrs, no return: 2hrs)	From 132.5m south-east of its junction with St Peter's Square south-eastwards for 53m
12) No waiting at any time	From 185.5m south-east of its junction with St Peter's Square south-eastwards for 12.5m
13) No waiting at any time & No loading at any time	From 198m south-east of its junction with St Peter's Square to 15m south-eastward of the south-eastern kerblines of Cantilupe Street
14) No waiting at any time & No loading, Monday-Sunday: 8:30am - 9:30am, 12:45pm - 2:15pm & 4:30pm - 6:30pm	From 15m south-east of the south-eastern kerblines of Cantilupe Street south-eastwards for 70m
15) No waiting at any time & No loading at any time	From 85m south-east of the south-eastern kerblines of Cantilupe Street to 20m south-east of the south-eastern kerblines of Mill Street

C. To introduce and restate (where there is no change) restrictions on the *north-east* side of **St Owen Street** (also known as *St Owen's Street*) as described in the table below:

Restriction	Extent
16) No waiting at any time & No loading, Monday-Sunday: 8:30am - 9:30am, 12:45pm - 2:15pm & 4:30pm - 6:30pm	From its junction with Bath Street (A438) to the boundary between 51 St Owen Street and 53 St Owen Street
17) No waiting at any time	From the boundary between 51 St Owen Street and 53 St Owen Street north-westwards for 25.5m
18) Disabled badge holders only, Monday - Saturday: 8.30am - 6pm (max stay: 2hrs, no return: 4hrs)	From 25.5m north-west of the boundary between 51 St Owen Street and 53 St Owen Street north-westwards for 13.5m
19) Pay & Display, Monday - Saturday: 8am - 6pm (max stay: 2 hrs, no return: 2hrs)	From 39m north-west of the boundary between 51 St Owen Street and 53 St Owen Street north-westwards for 22m
20) Loading only, Monday-Saturday: 6am-6pm (max stay: 30mins, no return: 1hr)	From 61m north-west of the boundary between 51 St Owen Street and 53 St Owen Street north-westwards for 10m
21) Informal crossing (noted for information only)	From 71m north-west of the boundary between 51 St Owen Street and 53 St Owen Street north-westwards for 10m
22) Pay & Display, Monday - Saturday: 8am - 6pm (max stay: 2 hrs, no return: 2hrs)	From 81m north-west of the boundary between 51 St Owen Street and 53 St Owen Street north-westwards for 28m
23) Disabled badge holders only, Monday - Saturday: 8.30am - 6pm (max stay: 2hrs, no return: 4hrs)	From 109m north-west of the boundary between 51 St Owen Street and 53 St Owen Street north-westwards for 13.5m
24) Pay & Display, Monday - Saturday: 8am - 6pm (max stay: 2 hrs, no return: 2hrs)	From 122.5m north-west of the boundary between 51 St Owen Street and 53 St Owen Street north-westwards for 57m
25) Informal crossing (noted for information only)	From 179.5m north-west of the boundary between 51 St Owen Street and 53 St Owen Street north-westwards for 10m
26) No waiting at any time & No loading at any time	From 189.5m north-west of the boundary between 51 St Owen Street and 53 St Owen Street north-westwards for 1.5m
27) No stopping except local buses	From 191m north-west of the boundary between 51 St Owen Street and 53 St Owen Street to its junction with St Peter's Square (continues in St Peter's Square)

D. To introduce and restate (where there is no change) restrictions on the east side of **St Peter's Square** as described in the table below:

Restriction	Extent
28) No stopping except local buses	From its junction with St Owen Street northwards for 2m (continued from St Owen Street)
29) No stopping except local buses	From 10m north of its junction with St Owen Street northwards for 22m
30) No waiting at any time & No loading at any time	From 32m north of its junction with St Owen Street to its junction with Union Street
31) Limited waiting for buses (max stay: 10mins, no return: 30mins)	The west side of the traffic island located east of the War Memorial - From the northern end of the traffic island southwards for 18m

(Please note the entire length of restrictions have been detailed in sequence, to help communicate the overall effect and that all parking / loading places will be marked parallel to the kerbside. Restrictions that are being retained are included for information purposes and may be commented on, but are not subject to formal consultation)

E. To introduce **No waiting at any time** and **No Loading at any time** on the follow lengths of road:

Road and side	Side and Length of kerbside
32) Mill Street, east side	From the south-west kerblines St Owen Street southwards for 25m

33) Mill Street, west side	From the south-west kerbline St Owen Street southwards for 23m
34) Cantilupe Street, south-east side	From the south-west kerbline of St Owen south-westwards for 9m
35) St Ethelbert Street, north-west side	From the south-west kerbline of St Owen Street south-westwards for 13.5m

NOTICE OF PROPOSAL

Herefordshire Council hereby gives notice that in exercise of its statutory enabling powers it is proposing to introduce the following road humps (constructed as flat-top tables, with ramps):

Location	Height
1) St Owen Street , From 1.5m south-east of the south-eastern boundary of 4 St Owen Street, south-eastwards for 10m (including ramps)	100mm
2) St Owen Street , From 6m south-east of the north-western boundary of 27 St Owen Street, south-eastwards for 10m (including ramps)	100mm
3) St Owen Street From the north-western boundary of 53 St Owen Street, south-eastwards for 27m (including ramps)	100mm
Cantilupe Street/St Ethelbert Street , From its junction with St Owen Street south-westwards for 6.5m (including ramps)	100mm

NOTICE OF PROPOSAL

Herefordshire Council hereby gives notice that in exercise of its statutory enabling powers it is proposing to make **THE COUNTY OF HEREFORDSHIRE DISTRICT COUNCIL (ST OWEN STREET CYCLE SCHEME, HEREFORD) (MOVEMENT) ORDER 2022**, the effect of which will be:

1. To update the existing no entry restriction that applies to the following length of road to include an exception for all buses, as signed:

Road	Description	Restricted Hours
St Peter's Square (east arm)	From its junction with Union Street southwards to its junction with St Owen Street	All

2. To introduce **mandatory contra-flow lanes** (all vehicles must travel in the direction specified, other than cycles travelling within the marked lane), as detailed in the table below:

Road	Extent	Direction
Mill Street	From its junction with St Owen Street to its junction with Green Street	Southwards
St Owen Street	From its junction with St Peter's Square to 14m north-west of its junction with Mill Street	South-eastwards
St Peter's Square (western arm)	From its junction with St Owen Street to its junction with Offa Street to its junction	South-eastwards

3. To introduce a **mandatory with-flow lane**, as detailed in the table below:

Road	Extent
St Ethelbert Street, east side	From its junction with St Owen Street southwards for 12.5m

NOTICE OF PROPOSAL

Herefordshire Council hereby gives notice that in exercise of its statutory enabling powers it is proposing to designate the section of footway detailed in the table below as a segregated **cycle tracks**:

Road	Extent
Mill Street & St Owen Street junction	West side, from Mill Street westwards for 14m and from St Owen Street southwards for 10m

(Please note that the footway will be extended and reconfigured to accommodate this facility and maintain a pedestrian route. There will also be slight change in the location of traffic signal controlled crossing)

A copy of the draft Orders, plans and statement of reasons are available for inspection during normal office hours at the Councils offices at Plough Lane, Hereford, HR4 0LE (phone: 01432 260000). They can also be viewed on the Traffic Regulation Order section of the Councils website (www.herefordshire.gov.uk/stowenstro). Photocopies of the documents may be provided on payment of the photocopying charges of the Council. Any queries can be directed by phone to 01432 261 800, or by e-mail to StOwenSt@balfourbeatty.com.

Objections to the scheme (stating the grounds on which they are made) and other representations relating to the scheme, must be received in writing on or before 16/06/2022 and should be sent to: St Owen St Consultation, Balfour Beatty Living Places, Unit 3, Thorn Business Park, Rotherwas Industrial Estate, Hereford, HR2 6JT or by completing the online response form at www.herefordshire.gov.uk/stowenstro Any representations received by the Council may be imparted to third parties.

Date: 19/05/2022

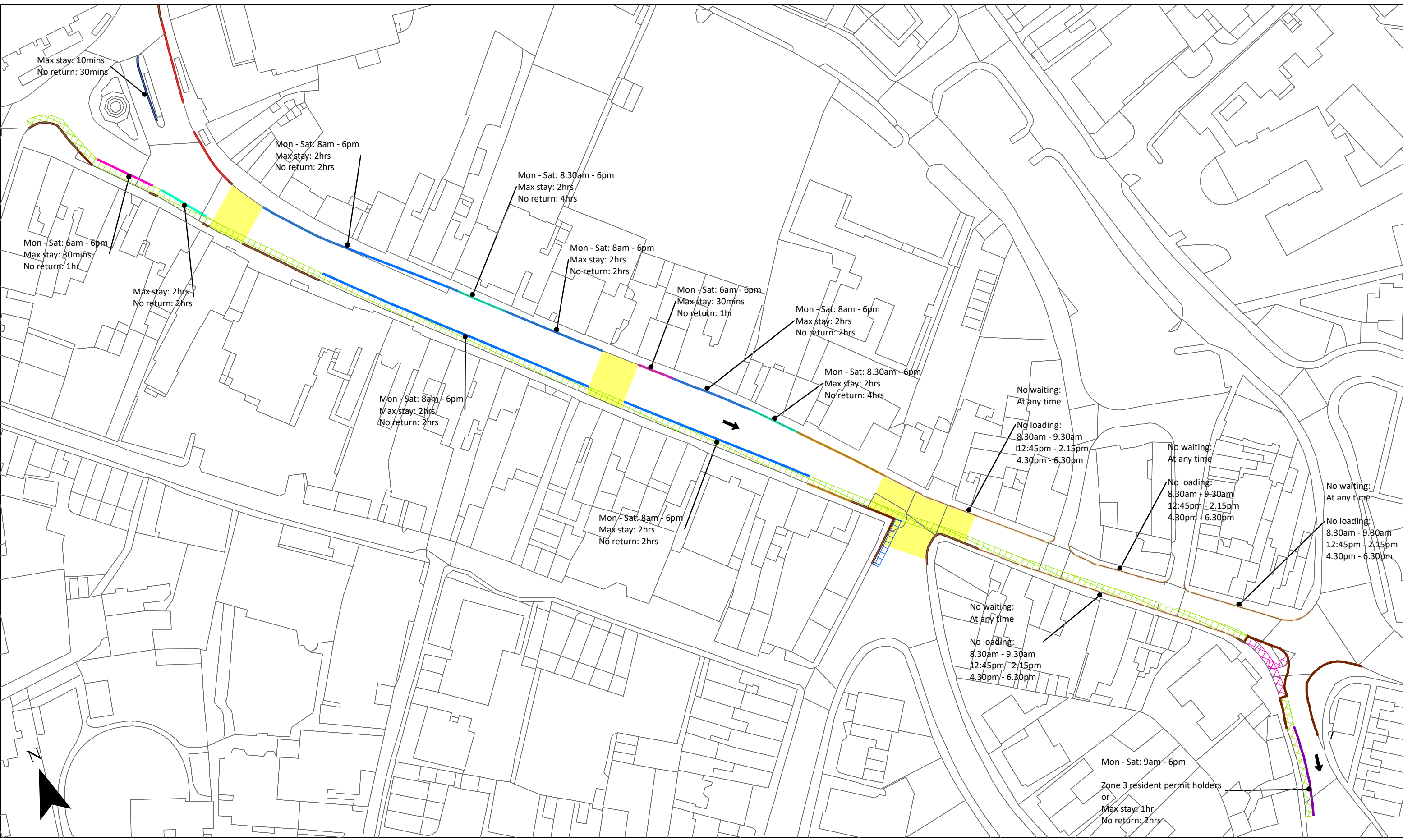

SOSC - TRO - v1

St Owen Street - Traffic Order Plan

- No waiting and no loading at any time
- Pay and display parking
- Limited waiting for buses
- Contra-flow cycle lane
- Road humps (flat top for informal crossing)
- No waiting and no loading during restricted hours
- Disabled badge holder parking
- Bus stop clearway
- With-flow cycle lane
- No waiting at any time
- Loading bay
- Permit parking or limited waiting
- Segregated cycle track

Note - on St Owen St (southern side) & Mill St (eastern side) the parking bays would be off-set from the kerb to accommodate the contra-flow cycle lane

**THE COUNTY OF HEREFORDSHIRE DISTRICT COUNCIL
(ST OWEN STREET CYCLE SCHEME, HEREFORD) (MOVEMENT) ORDER 2022**

The County of Herefordshire District Council (“the Council”) in exercise of its powers under sections 1 and 2 Road Traffic Regulation Act 1984 (referred to as “the 1984 Act”), and of all other enabling powers, and after consultation with the Chief Officer of Police in accordance with Part III of Schedule 9 to the 1984 Act proposes to make the following Order:-

PART ONE — INTRODUCTION

CITATION

- 1.1 This Order shall come into operation on the [[DATE]] and may be cited as The County of Herefordshire District Council (St Owen Street Cycle Scheme, Hereford) (Movement) Order 2022.

INTERPRETATION

- 1.2 In this Order, except where otherwise stated, any reference to an Article or Schedule shall be construed as a reference to that Article or Schedule in this order.
- 1.3 In this Order any reference to an Act, Statutory Instrument, Regulation or Order shall be construed as a reference to that Act, Statutory Instrument or Order as amended.
- 1.4 In this Order the following expressions shall have the respective meanings assigned to them:

“Bus”: a motor vehicle constructed or adapted to carry more than 8 passengers (exclusive of the driver);

“Civil Enforcement Officer” means a person appointed in accordance with the provisions of Section 76 Traffic Management Act 2004.

“Council” means The County of Herefordshire District Council (known as Herefordshire Council).

‘Pedal Cycle’ has the same meaning as in Section 192 of the Road Traffic Act 1988. Electrically assisted cycles meeting the Electrically Assisted Pedal Cycles (EAPC) requirements are classed as a cycle.

“Motor Vehicle” means a mechanically propelled vehicle intended or adapted for use on the roads as defined in Section 185 of the Road Traffic Act 1988.

“Passenger Vehicle” means a vehicle constructed or adapted for the carriage of passengers and their effects.

PART TWO — MOVEMENT RESTRICTIONS

NO ENTRY EXCEPT BUSES

- 2.1** No person shall cause or permit any vehicle other than a bus to enter or travel along the lengths of road specified in columns 1 and 2 of schedule 1.
- 2.2** Nothing in Article 2.1 shall prohibit any vehicle from entering or travelling along the lengths of road in the following circumstances:
- a) Under the direction of a police officer or Civil Enforcement Officer or with the prior consent of the Council provided that any conditions imposed are complied with
 - b) The vehicle is being used for emergency services purposes
 - c) To enable the vehicle, not being a Passenger Vehicle, to be used for the purpose of any building operation, demolition or excavation or the maintenance, improvement or reconstruction of the road or the laying erection, alteration, removal or repair of any sewer or of any main, pipe or apparatus for the supply of gas, water or electricity or any telegraphic line or traffic sign in the road provided that notice is given twenty-four hours in advance to the Council and their consent is obtained and any conditions imposed are complied with
 - d) The vehicle is a statutory undertaker liveried utility company vehicle being used in connection with works of that utility in the immediate vicinity
 - e) For street cleansing and refuse collection or for purposes associated with the maintenance of the highway, street furniture or fabric of the highway.

WITH-FLOW CYCLE LANE

- 2.3** No person shall cause or permit any vehicle other than a Pedal Cycle to enter or travel along the lengths of road specified in schedule 2 within the cycle lane separated from the rest of the carriageway by a road marking to Diagram 1049B of the TSRGD.
- 2.4** Nothing in Article 2.3 shall prohibit any vehicle from entering or travelling along the lengths of road in the following circumstances:
- a) Under the direction of a police officer or Civil Enforcement Officer or with the prior consent of the Council provided that any conditions imposed are complied with
 - b) The vehicle is being used for emergency services purposes
 - c) To enable the vehicle, not being a Passenger Vehicle, to be used for the purpose of any building operation, demolition or excavation or the maintenance, improvement or reconstruction of the road or the laying erection, alteration, removal or repair of any sewer or of any main, pipe or apparatus for the supply of gas, water or electricity or any telegraphic line or traffic sign in the road provided that notice is given twenty-four hours in advance to the Council and their consent is obtained and any conditions imposed are complied with
 - d) The vehicle is a statutory undertaker liveried utility company vehicle being used in connection with works of that utility in the immediate vicinity

- e) For street cleansing and refuse collection or for purposes associated with the maintenance of the highway, street furniture or fabric of the highway

CONTRA-FLOW CYCLE LANE

- 2.5** No person shall cause or permit any vehicle to travel along the lengths of road specified in column 1 and 2 of schedule 3, other than in the direction specified in column 4 of schedule 3.
- 2.6** Article 2.5 shall not apply to a Pedal Cycle traveling in the direction specified in column 3 of schedule 3 within a contra-flow cycle lane, separated from the rest of the carriageway by a road marking to Diagram 1049B of the TSRGD.
- 2.7** No person shall cause or permit any vehicle other than a Pedal Cycle to enter or travel along the lengths of road specified in column 1 and 2 of schedule 3 within the contra-flow cycle lane, separated from the rest of the carriageway by a road marking to Diagram 1049B of the TSRGD.
- 2.8** Nothing in article 2.5, 2.6 or 2.7 shall prohibit any vehicle from entering of travelling along the lengths of road in the following circumstances:
 - a) Under the direction of a police officer or Civil Enforcement Officer or with the prior consent of the Council provided that any conditions imposed are complied with
 - b) The vehicle is being used for emergency services purposes
 - c) To enable the vehicle, not being a Passenger Vehicle, to be used for the purpose of any building operation, demolition or excavation or the maintenance, improvement or reconstruction of the road or the laying erection, alteration, removal or repair of any sewer or of any main, pipe or apparatus for the supply of gas, water or electricity or any telegraphic line or traffic sign in the road provided that notice is given twenty-four hours in advance to the Council and their consent is obtained and any conditions imposed are complied with
 - d) The vehicle is a statutory undertaker liveried utility company vehicle being used in connection with works of that utility in the immediate vicinity
 - e) For street cleansing and refuse collection or for purposes associated with the maintenance of the highway, street furniture or fabric of the highway

ONE-WAY ROADS

- 2.9** No person shall cause or permit any vehicle to travel along the lengths of road specified in column 1 and 2 of schedule 4 other than in the direction specified in column 3 of schedule 4.
- 2.10** Nothing in article 2.9 shall prohibit any vehicle from entering of travelling along the lengths of road in the following circumstances:
 - a) Under the direction of a police officer or Civil Enforcement Officer or with the prior consent of the Council provided that any conditions imposed are complied with
 - b) The vehicle is being used for emergency services purposes
 - c) To enable the vehicle, not being a Passenger Vehicle, to be used for the purpose of any building operation, demolition or excavation or the maintenance, improvement or reconstruction of the road or the laying erection, alteration,

removal or repair of any sewer or of any main, pipe or apparatus for the supply of gas, water or electricity or any telegraphic line or traffic sign in the road provided that notice is given twenty-four hours in advance to the Council and their consent is obtained and any conditions imposed are complied with

- d) The vehicle is a statutory undertaker liveried utility company vehicle being used in connection with works of that utility in the immediate vicinity
- e) For street cleansing and refuse collection or for purposes associated with the maintenance of the highway, street furniture or fabric of the highway

PART THREE - REVOCATIONS

3.1 Without prejudice to the validity of anything done or to any liability incurred in respect of any act or omission before the coming into operation of this Order, the following Orders will be revoked in their entirety from the date stated in Article 1.1:

- a) The County of Hereford and Worcester (St. Peter's Square, St. Owen Street and Mill Street, Hereford) (One-Way Traffic) Order 1987
- b) The City of Hereford and Worcester (St Peter's Square and Union Street, Hereford) (Prohibition of Driving) Order 1988.

Dated this day of 2022

THE COMMON SEAL of
THE COUNTY OF HEREFORDSHIRE
DISTRICT COUNCIL was hereunto
affixed BY ORDER

..... Authorised Officer

Schedule 1 – No entry except buses

Column 1	Column 2
Road	Description
St Peter's Square (U80010) (east arm)	From its junction with Union Street (U80011) southwards to its junction with St Owen Street (U80010, also known as St Owen's Street)

Schedule 2 – With-flow cycle lanes

Schedule 2: With-flow cycle lane		
Column 1	Column 2	Column 3
Road	Side	Extent
St Ethelbert Street	East	From its junction with St Owen Street southwards for 12.5m

Schedule 3 – Contra-flow cycle lanes

Column 1	Column 2	Column 3	Column 4
Road	Extent	Cycle Direction of Travel	Direction of Travel
Mill Street (U80023)	From its junction with St Owen Street (U80010, also known as St Owen's Street) to its junction with Green Street	North	South
St Owen Street (U80010, also known as St Owen's Street)	From its junction with St Peter's Square (U80010) to 15m north-west of its junction with Mill Street	North-west	South-east
St Peter's Square (U80010) (south-western arm)	From its junction with Offa Street to its junction with St Owen Street (U80010, also known as St Owen's Street)	North-west	South-east

Schedule 4 – One-way

Column 1	Column 2	Column 3
Road	Extent	Direction of Travel
St Peter's Square (U80010) (northern arm)	From its junction with Offa Street to its junction with St Owen Street (U80010, also known as St Owen's Street)	South-west
St Owen Street (U80010, also known as St Owen's Street)	From its junction with Mill Street north-westwards for 15m	South-west
Mill Street (U80023)	From its junction with Green Street to its junction with Cantilupe Street	South

**THE COUNTY OF HEREFORDSHIRE DISTRICT COUNCIL
(ST OWEN STREET CYCLE SCHEME, HEREFORD) ORDER 2022**

The Council in exercise of its powers under Sections 1, 2, 4, 32(1), 35(1), 45, 46, 49, 53 and Part IV of Schedule 9 to the Road Traffic Regulation Act 1984 (“the 1984 Act”) and of all other enabling powers, and after consultation with the Chief Officer of Police in accordance with Part III of Schedule 9 to the 1984 Act, hereby make the following Order:

CITATION AND COMMENCEMENT

- 1 This Order shall come into operation on the _____ 2022 and may be cited as The County of Herefordshire District Council (St Owen Street Cycle Scheme, Hereford) Order 2022.

INTERPRETATION

- 2 In this Order:
- (a) except where otherwise stated, any reference to an Article or Schedule shall be construed as a reference to that Article or Schedule in this Order.
 - (b) any reference to an Act, Statutory Instrument, Regulation or Order shall be construed as a reference to that Act, Statutory Instrument or Order as amended.
 - (c) “Principal Order” shall mean The County of Herefordshire District Council (Hereford City Centre) Order 2017.

AMENDMENTS

- 3 The contents of Schedule 1 shall be deleted from Schedule 1 the Principal Order.
- 4 The contents of Schedule 2 shall be inserted into Schedule 1 to the Principal Order.
- 5 The contents of Schedule 3 shall be deleted from Schedule 2 to the Principal Order.
- 6 The contents of Schedule 4 shall be inserted into Schedule 2 to the Principal Order.
- 7 The contents of Schedule 5 shall be deleted from Schedule 4 to the Principal Order.
- 8 The contents of Schedule 6 shall be inserted into Schedule 4 to the Principal Order.
- 9 The contents of Schedule 7 shall be deleted from Schedule 5 to the Principal Order.
- 10 The contents of Schedule 8 shall be inserted into Schedule 5 to the Principal Order.
- 11 The contents of Schedule 9 shall be deleted from Schedule 6 to the Principal Order.
- 12 The contents of Schedule 10 shall be inserted into Schedule 6 to the Principal Order.
- 13 The contents of Schedule 11 shall be deleted from Schedule 9 to the Principal Order.
- 14 The contents of Schedule 12 shall be inserted into Schedule 9 to the Principal Order.
- 15 The contents of Schedule 13 shall be deleted from Schedule 10 to the Principal Order.
- 16 The contents of Schedule 14 shall be inserted into Schedule 10 to the Principal Order.
- 17 The contents of Schedule 15 shall be deleted from Schedule 11 to the Principal Order.
- 18 The contents of Schedule 16 shall be inserted into Schedule 11 to the Principal Order.

Dated this day of 2022

**THE COMMON SEAL of
THE COUNTY OF HEREFORDSHIRE
DISTRICT COUNCIL** was hereunto
affixed **BY ORDER**

..... Authorised Officer

DRAFT

Schedule 1 – No waiting at any time (deletion from schedule 1 of the Principal Order)

Column 1	Column 2	Column 3
Road	Side	Description
St. Ethelbert Street (U80019)	North-west	From the south-west kerbline of St Owen Street south-westwards for 15m
St Owen's Street (also known as St Owen Street U80010)	North-east	From 18m south-east of its junction with St Peter's Square south-eastwards for 1.5m
St Owen's Street (also known as St Owen Street U80010)	North-east	From 180.1m south-east of its junction with St Peter's Square south-eastwards to its junction with Bath Street
St Owen's Street (also known as St Owen Street U80010)	South-west	From 66.9m south-east of the south-eastern kerbline of Offa Street south-eastwards for 20.6m
St Owen's Street (also known as St Owen Street U80010)	South-west	From 225.2m south-east of the south-eastern kerbline of Offa Street south-eastwards to 5m north-west of the extended rear boundary line of 15 St Owens Gate
St. Peter's Square (U80010)	East	From its junction with Union Street southwards for 3m
St. Peter's Square (U80010)	South-west	From the south-eastern kerbline of Offa Street south-eastwards for 16m

Schedule 2 – No waiting at any time (addition to schedule 1 of the Principal Order)

Column 1	Column 2	Column 3
Road	Side	Description
St Ethelbert Street (U80019)	north-west	From the south-west kerbline of St Owen Street south-westwards for 13.5m
St Owen Street (U80010)	North-east	From the boundary between 51 St Owen Street and 53 St Owen Street north-westwards for 25.5m
St Owen Street (U80010)	North-east	From 189.5m north-west of the boundary between 51 St Owen Street and 53 St Owen Street north-westwards for 1.5m
St Owen Street (U80010)	North-east	From its junction with Bath Street (A438) to the boundary between 51 St Owen Street and 53 St Owen Street
St Owen Street (U80010)	South-west	From 185.5m south-east of its junction with St Peter's Square south-eastwards for 12.5m
St Owen Street (U80010)	South-west	From 11.5m south-east of its junction with St Peter's Square south-eastwards for 2m
St Owen Street (U80010)	South-west	From 198m south-east of its junction with St Peter's Square to 15m south-eastward of the south-eastern kerbline of Cantilupe Street
St Owen Street (U80010)	South-west	From 85m south-east of the south-eastern kerbline of Cantilupe Street to 20m south-east of the south-eastern kerbline of Mill Street
St Owen Street (U80010)	South-west	From 23.5m south-east of its junction with St Peter's Square south-eastwards for 22.5m
St Owen Street (U80010)	South-west	From 15m south-east of the south-eastern kerbline of Cantilupe Street south-eastwards for 70m

Column 1	Column 2	Column 3
Road	Side	Description
St Peter's Square (U80010)	East	From 32m north of its junction with St Owen Street to its junction with Union Street
St Peter's Square (U80010)	South-west	From the south-eastern kerbline of Offa Street south-eastwards for 20m
St Peter's Square (U80010)	South-west	From 36.5m south-east of the south-eastern kerbline of Offa Street south-eastwards for 2.5m

Schedule 3 - No waiting during restricted hours (deletion from schedule 2 of the Principal Order)

Column 1	Column 2	Column 3	Column 4
Road	Side	Description	Restricted Hours
St. Ethelbert Street (U80019)	North-west	From 11.5m north-east of the north-eastern kerbline of Castle Street north-eastwards to 15m south-west of the south-western kerbline of St Owen Street.	Monday to Saturday 8am - 6:30pm

Schedule 4 - No waiting during restricted hours (addition to schedule 2 of the Principal Order)

Column 1	Column 2	Column 3	Column 4
Road	Side	Description	Restricted Hours
St. Ethelbert Street (U80019)	North-west	From 11.5m north-east of the north-eastern kerbline of Castle Street north-eastwards to 13.5m south-west of the south-western kerbline of St Owen Street.	Monday to Saturday 8am - 6:30pm

Schedule 5 - No loading at any time (deletion from schedule 4 of the Principal Order)

Column 1	Column 2	Column 3
Road	Side	Description
Cantilupe Street (U80022)	South-east	From the south-west kerbline of St Owen south-westwards for 9m
St. Ethelbert Street (U80019)	North-west	From the south-west kerbline of St Owen Street south-westwards for 15m
St. Owen's Street (also known as St. Owen Street) (U80010)	South-west	From 66.9m south-east of the south-eastern kerbline of Offa Street south-eastwards for 20.6m
St. Owen's Street (also known as St. Owen Street) (U80010)	South-west	From 242.7m south-east of the south-eastern kerbline of Offa Street south-eastwards for 30.4m
St. Owen's Street (also known as St. Owen Street) (U80010)	South-west	From 345m south-east of the south-eastern kerbline of Offa Street south-eastwards to 5m north-west of the extended rear boundary line of 15 St Owens Gate
St. Peter's Square (U80010)	East	From its junction with Union Street southwards for 3m

Column 1	Column 2	Column 3
Road	Side	Description
St. Peter's Square (U80010)	South-west	From the south-eastern kerblines of Offa Street south-eastwards for 16m

Schedule 6 - No loading at any time (addition to schedule 4 of the Principal Order)

Column 1	Column 2	Column 3
Road	Side	Description
Mill Street (U80023)	East	From the south-west kerblines of St Owen Street southwards for 25m
Mill Street (U80023)	West	From the junction of St Owen Street southwards for 23m
St Ethelbert Street (U80019)	north-west	From the south-west kerblines of St Owen Street south-westwards for 13.5m
St Owen Street (U80010)	North-east	From 189.5m north-west of the boundary between 51 St Owen Street and 53 St Owen Street north-westwards for 1.5m
St Owen Street (U80010)	South-west	From 11.5m south-east of its junction with St Peter's Square south-eastwards for 2m
St Owen Street (U80010)	South-west	From 198m south-east of its junction with St Peter's Square to 15m south-eastward of the south-eastern kerblines of Cantilupe Street
St Owen Street (U80010)	South-west	From 85m south-east of the south-eastern kerblines of Cantilupe Street to 20m south-east of the south-eastern kerblines of Mill Street
St Owen Street (U80010)	South-west	From 23.5m south-east of its junction with St Peter's Square south-eastwards for 22.5m
St Peter's Square (U80010)	East	From 32m north of its junction with St Owen Street to its junction with Union Street
St Peter's Square (U80010)	South-west	From the south-eastern kerblines of Offa Street south-eastwards for 20m
St Peter's Square (U80010)	South-west	From 36.5m south-east of the south-eastern kerblines of Offa Street south-eastwards for 2.5m

Schedule 7 - No loading during restricted hours (deletion from schedule 5 of the Principal Order)

Column 1	Column 2	Column 3	Column 4
Road	Side	Description	Restricted Hours
St. Owen's Street (also known as St. Owen Street) (U80010)	North-east	From 206m south-east of its junction with St Peter's Square south-eastwards to its junction with Bath Street	8:30am – 9:30am, 12:45pm – 2:15pm and 4:30pm – 6:30pm

Column 1	Column 2	Column 3	Column 4
Road	Side	Description	Restricted Hours
St. Owen's Street (also known as St. Owen Street) (U80010)	South-west	From 273.1m south-east of the south-eastern kerbline of Offa Street south-eastwards for 71.9m	8:30am – 9:30am, 12:45pm – 2:15pm and 4:30pm – 6:30pm

Schedule 8 - No loading during restricted hours (addition to schedule 5 of the Principal Order)

Column 1	Column 2	Column 3	Column 4
Road	Side	Description	Restricted Hours
St Owen Street (U80010)	North-east	From its junction with Bath Street (A438) to the boundary between 51 St Owen Street and 53 St Owen Street	Monday to Saturday 8:30am - 9:30am, 12:45pm - 2:15pm and 4:30pm - 6:30pm
St Owen Street (U80010)	South-west	From 15m south-east of the south-eastern kerbline of Cantilupe Street south-eastwards for 70m	Monday to Saturday 8:30am - 9:30am, 12:45pm - 2:15pm and 4:30pm - 6:30pm

Schedule 9 – Limited waiting for buses (deletion from schedule 6 of the Principal Order)

Column 1	Column 2	Column 3	Column 4	Column 5	Column 6
Road	Side	Description	Restricted Hours	Maximum Stay	No Return
St. Peter's Square (U80010)	West (of bus island)	From 1.5m north of the southern end of the bus interchange island northwards for 18m	All	10 Minutes	30 Minutes

Schedule 10 – Limited waiting for buses (addition to schedule 6 of the Principal Order)

Column 1	Column 2	Column 3	Column 4	Column 5	Column 6
Road	Side	Description	Restricted Hours	Maximum Stay	No Return
St Peter's Square (U80010)	The west side of the traffic island located east of the War Memorial	From the northern end of the traffic island southwards for 18m	All	10 minutes	30 minutes

Schedule 11 - Disabled badge holder parking (deletion from schedule 9 of the Principal Order)

Column 1	Column 2	Column 3	Column 4	Column 5	Column 6
Road	Side	Description	Restricted Hours	Maximum Stay	No Return
St. Owen's Street (also known as St. Owen Street) (U80010)	North-east	From 83.9m south-east of its junction with St Peter's Square south-eastwards for 13.2m	Monday to Saturday 8:30am - 6pm	2 Hours	4 Hours
St. Owen's Street (also known as St. Owen Street) (U80010)	North-east	From 166.8m south-east of its junction with St Peter's Square south-eastwards for 13.3m	Monday to Saturday 8:30am - 6pm	2 Hours	4 Hours
St. Owen's Street (also known as St. Owen Street) (U80010)	South-west	From 41.7m south-east of the south-eastern kerbline of Offa Street south-eastwards for 4.7m	All	2 Hours	2 Hours
St. Peter's Square (U80010)	South-west	From 33.5m south-east of the south-eastern kerbline of Offa Street south-eastwards for 8.2m	All	2 Hours	2 Hours

Schedule 12 - Disabled badge holder parking (addition to schedule 9 of the Principal Order)

Column 1	Column 2	Column 3	Column 4	Column 5	Column 6
Road	Side	Description	Restricted Hours	Maximum Stay	No Return
St Owen Street (U80010)	South-west	From its junction with St Peter's Square south-eastwards for 11.5m (continued from St Peter's Square)	All	2 Hours	2 Hours
St Peter's Square (U80010)	South-west	From 36.5m south-east of the south-eastern kerbline of Offa Street south-eastwards to its junction with St Owen Street (continues in St Owen Street)	All	2 Hours	2 Hours
St Owen Street (U80010)	North-east	From 25.5m north-west of the boundary between 51 St Owen Street and 53 St Owen Street north-westwards for 13.5m	Monday to Saturday 8:30am - 6pm	2 Hours	4 Hours

St Owen Street (U80010)	North-east	From 109m north-west of the boundary between 51 St Owen Street and 53 St Owen Street north-westwards for 13.5m	Monday to Saturday 8:30am - 6pm	2 Hours	4 Hours
-------------------------	------------	--	---------------------------------	---------	---------

Schedule 13 - Pay & Display (deletion from schedule 10 of the Principal Order)

Column 1	Column 2	Column 3	Column 4	Column 5	Column 6
Road	Side	Description	Restricted Hours	Maximum Stay	No Return
St. Owen's Street (also known as St. Owen Street) (U80010)	North-east	From 29.1m south-east of its junction with St Peter's Square south-eastwards for 54.8m	Monday to Saturday 8am - 6pm	2 hours	2 hours
St. Owen's Street (also known as St. Owen Street) (U80010)	North-east	From 97.1m south-east of its junction with St Peter's Square south-eastwards for 27.7m	Monday to Saturday 8am - 6pm	2 hours	2 hours
St. Owen's Street (also known as St. Owen Street) (U80010)	North-east	From 144.8m south-east of its junction with St Peter's Square south-eastwards for 22m	Monday to Saturday 8am - 6pm	2 hours	2 hours
St. Owen's Street (also known as St. Owen Street) (U80010)	South-west	From 46.4m south-east of the south-eastern kerbline of Offa Street south-eastwards for 10.9m	Monday to Saturday 8am - 6pm	2 hours	2 hours
St. Owen's Street (also known as St. Owen Street) (U80010)	South-west	From 87.5m south-east of the south-eastern kerbline of Offa Street south-eastwards for 76.5m	Monday to Saturday 8am - 6pm	2 hours	2 hours
St. Owen's Street (also known as St. Owen Street) (U80010)	South-west	From 173.6m south-east of the south-eastern kerbline of Offa Street south-eastwards for 51.6m	Monday to Saturday 8am - 6pm	2 hours	2 hours

Schedule 14 - Pay & Display (addition to schedule 10 of the Principal Order)

Column 1	Column 2	Column 3	Column 4	Column 5	Column 6
Road	Side	Description	Restricted Hours	Maximum Stay	No Return
St Owen Street (U80010)	North-east	From 39m north-west of the boundary between 51 St Owen Street and 53 St Owen Street north-westwards for 22m	Monday to Saturday 8am - 6pm	2 hours	2 hours
St Owen Street (U80010)	North-east	From 81m north-west of the boundary between 51 St Owen Street and 53 St Owen Street north-westwards for 28m	Monday to Saturday 8am - 6pm	2 hours	2 hours
St Owen Street (U80010)	North-east	From 122.5m north-west of the boundary between 51 St Owen Street and 53 St Owen Street north-westwards for 57m	Monday to Saturday 8am - 6pm	2 hours	2 hours
St Owen Street (U80010)	South-west	From 46m south-east of its junction with St Peter's Square south-eastwards for 76.5m	Monday to Saturday 8am - 6pm	2 hours	2 hours
St Owen Street (U80010)	South-west	From 132.5m south-east of its junction with St Peter's Square south-eastwards for 53m	Monday to Saturday 8am - 6pm	2 hours	2 hours

Schedule 15 - Loading bay (deletion from schedule 11 of the Principal Order)

Column 1	Column 2	Column 3	Column 4	Column 5	Column 6
Road	Side	Description	Restricted Hours	Maximum Stay	No Return
St. Owen's Street (also known as St. Owen Street) (U80010)	North-east	From 134.4m south-east of its junction with St Peter's Square south-eastwards for 10.4m	6am - 6pm	30 minutes	1 hour
St. Peter's Square (U80010)	South-west	From 16m south-east of the south-eastern kerbline of Offa Street south-eastwards for 17.5m	6am - 6pm	30 minutes	1 hour

Schedule 16 - Loading bay (addition to schedule 11 of the Principal Order)

Column 1	Column 2	Column 3	Column 4	Column 5	Column 6
Road	Side	Description	Restricted Hours	Maximum Stay	No Return
St Owen Street (U80010)	North-east	From 61m north-west of the boundary between 51 St Owen Street and 53 St Owen Street north-westwards for 10m	Monday to Saturday 6am - 6pm	30 minutes	1 hour

Column 1	Column 2	Column 3	Column 4	Column 5	Column 6
Road	Side	Description	Restricted Hours	Maximum Stay	No Return
St Peter's Square (U80010)	South-west	From 20m south-east of the south-eastern kerbline of Offa Street south-eastwards for 16.5m	Monday to Saturday 6am - 6pm	30 minutes	1 hour

DRAFT

ST OWEN STREET CYCLE SCHEME

Statement of Reasons

The overall scheme aligns with Government policy, as outlined in the Department of Transport Cycling and Walking Investment Strategy: Safety Review, to promote sustainable and active travel for an improved urban environment.

1. The County of Herefordshire District Council (St Owen Street Cycle Scheme, Hereford) (Movement) Order 2022

Following extended informal consultation with residents, businesses and other stakeholders, the Council is proposing this Traffic Regulation Order (TRO) to improve cycle access to Hereford city centre from the east via St Owen Street. Also to improve the amenity of the locality, the order updates an existing prohibition of driving to reflect the restriction signed (no entry expect buses through the bus interchange). The order therefore facilitates the passage on the road of cyclists and buses.

In authorising the advertisement of these proposals the Council has given consideration to its duty under s122 of the Road Traffic Regulation Act 1984 to secure the expeditious, convenient and safe movement of vehicular and other traffic (including pedestrians) and the provision of suitable and adequate parking facilities on and off the highway (while having regard to the matters specified in s122 subsection (2) of that Act)

Herefordshire Council reserves the right to produce an amended or further statement, in the context of any public inquiry or judicial proceedings to these proposals.

2. The County of Herefordshire District Council (St Owen Street Cycle Scheme, Hereford) (Waiting and Parking) Order 2022

The revised road alignment to accommodate cycle movement and remove echelon parking requires a rearrangement and retention of waiting, loading and parking restrictions on St Owen Street/St Peter's Square and around accesses from Mill Street and Cantilupe Street/St Ethelbert Street. These measures are proposed to help preserve the amenity of the locality. The removal of echelon parking bays will reduce the risk of accidents from reversing movements and is proposed to avoid danger to persons or other traffic using the road or any other road or for preventing the likelihood of any such danger arising.

In authorising the advertisement of these proposals the Council has given consideration to its duty under s122 of the Road Traffic Regulation Act 1984 to secure the expeditious, convenient and safe movement of vehicular and other traffic (including pedestrians) and the provision of suitable and adequate parking facilities on and off the highway (while having regard to the matters specified in s122 subsection (2) of that Act)

Herefordshire Council reserves the right to produce an amended or further statement, in the context of any public inquiry or judicial proceedings to these proposals.

3. Traffic Calming (Road Hump) Notice

In order to reduce 85th percentile speeds in keeping with a 20mph speed limit, three raised tables are proposed. These measures are proposed to avoid danger to persons or other traffic using the road or any other road or for preventing the likelihood of any such danger arising.

4. Cycle Track Notice

In order to facilitate cycle access from Mill Street north-westwards into the city centre via St Owen Street, a segregated cycle track is proposed on the west side of this junction. The footway will be reconfigured, and a pedestrian route maintained. The current crossing facility

at the traffic signals is also being enhanced to provide a pedestrian call facility.