



To: Hereford and Worcester County Council

STATEMENT PURSUANT TO SECTION 31(6) HIGHWAYS ACT 1980

On the th 13 day of January 1997 I wish to deposit with Hereford and Worcester County Council, being the appropriate Council, a statement accompanied by a plan delineating my property by red edging which states that the ways coloured brown on the said plan and the plan accompanying this declaration have been dedicated as highways with vehicular status, the ways coloured green on the said plan and on the plan accompanying this declaration have been dedicated as bridleways; the ways coloured purple on the said plan and on the plan accompanying this declaration have been dedicated footpaths; no other ways have been dedicated as highways over the property.

Signed

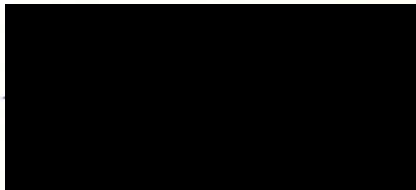

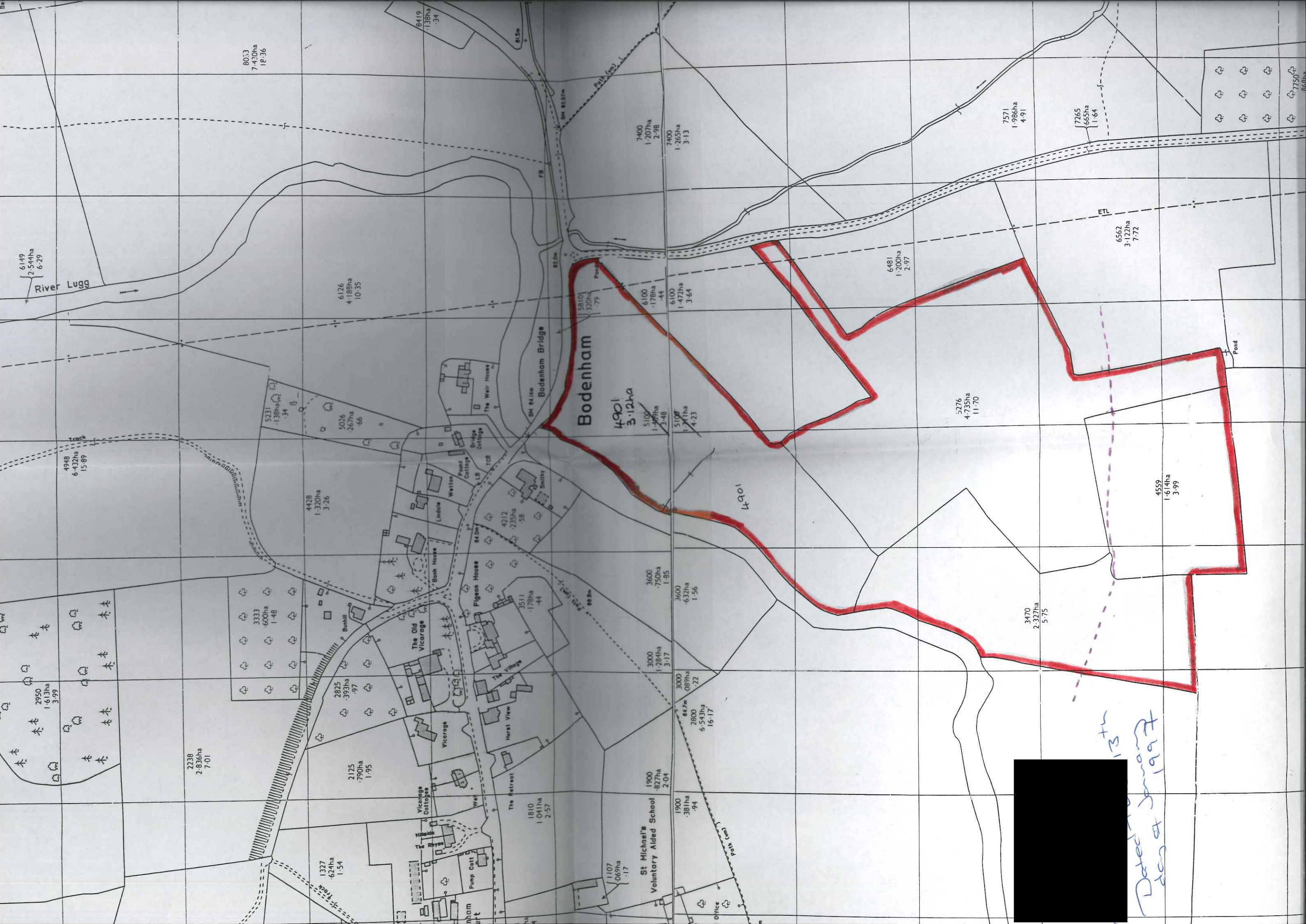

8053
7.420ha
18.36

6149
2.544ha
6.29
River Lugg

6126
4.188ha
10.35

7400
1.207ha
2.98

7400
1.265ha
3.13

7571
1.986ha
4.91

7265
665ha
1.64

6562
3.122ha
7.72

6481
1.200ha
2.97

Bodenham
4901
3.12ha

5100
1.469ha
3.48

5100
1.472ha
3.64

5276
4.735ha
11.70

4559
1.614ha
3.99

4428
1.320ha
3.26

5231
1.38ha
3.4

5026
2.67ha
6.6

4948
6.432ha
15.89

3600
750ha
1.85

3600
632ha
1.56

3000
1.284ha
3.17

3000
689ha
2.2

2800
6.543ha
16.17

2238
2.836ha
7.01

2125
790ha
1.95

1900
827ha
2.04

1900
381ha
0.94

1810
1.041ha
2.57

1107
0.69ha
1.7

St Michael's
Voluntary Aided School

Dated 13th
Jan 1997
at 1997