

DEPOSIT OF STATEMENT AND PLAN

SECTION 31 (6) OF THE HIGHWAYS ACT 1980

To The Rights of Way Section,  
Environmental Services,  
Hereford & Worcester County Council,  
County Hall,  
Spetchley Road,  
WORCESTER WR5 2NP

1. I am and have been since the 1966 employed by Marston Thompson & Evershed p.l.c. of P.O. Box. No.26, Shobnall Road, Burton upon Trent, Staffordshire and have been the duly appointed Property Manager since 1984 (now appointed Group Property Manager)

2. Marston Thompson & Evershed p.l.c. have since the 4th day of February 1971 (then as Marston Thompson & Evershed Limited) been the owner within the meaning of the above Section of the land known as The Royal Oak, Church Street, Kington in the County of Hereford and Worcester more particularly delineated on the plan accompanying this statement and thereon edged red

3. The aforementioned land lies in the parish of Kington town

4. No ways over the land have been dedicated as highways or footpaths

5. The deposit shall comprise this statement and accompanying plan signed by and on behalf of Marston Thompson & Evershed p.l.c.

Signed.....

Group Property Manager.



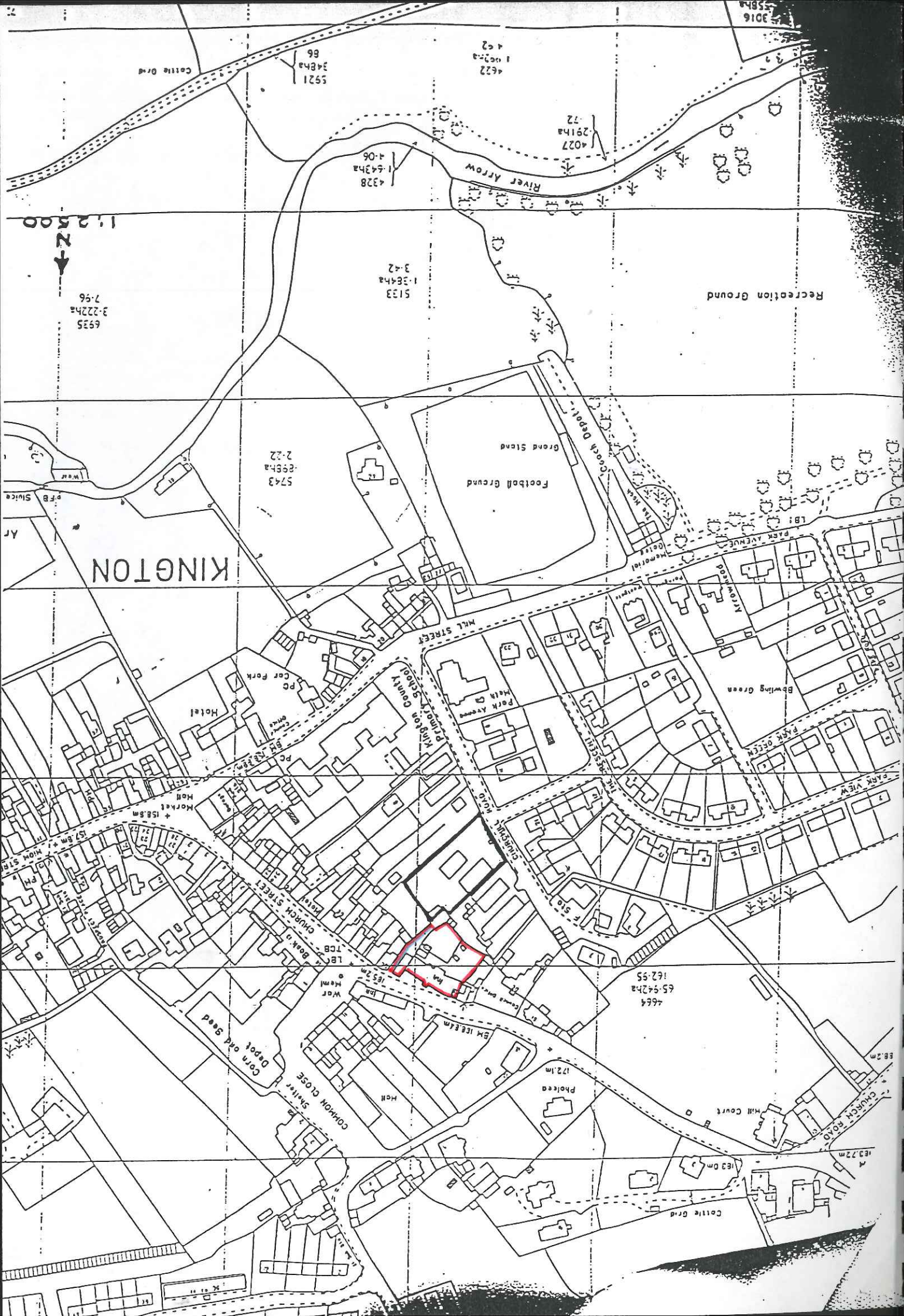

KINGSTON

River Arrow

Recreation Ground

Football Ground

Coach Depot

Hotel

King's County Primary School

Hill Street

Church Street

4664  
65-542ha  
162-55

6935  
3-222ha  
7-96

5133  
1-364ha  
3-42

5743  
2-22  
2-22ha

5921  
348ha  
86

4622  
1-022ha  
4-02

4027  
291ha  
72

4328  
1-643ha  
4-06

3016  
558ha

Cotton Grid

Cotton Grid

Hill Court

Church Road

Park View

Park Green

Bowling Green

Park Avenue

Hill Street

King's County Primary School

Hotel

Church Street

Market

Hotel

Hotel

Hotel

Hotel

Hotel

Hotel

Hotel

Hotel

Hotel

Hotel

Hotel

Hotel

Hotel

Hotel

Hotel

STATUTORY DECLARATION

SECTION 31(6) OF THE HIGHWAYS ACT 1980

I PHILIP JOSEPH WEBB of 12 Beowulf Covert, Stretton, Burton-on-Trent,

Staffordshire

DO SOLEMNLY AND SINCERELY DECLARE as follows:-

1. I am and have been employed since the 1966 by Marston Thompson & Evershed p.l.c. of P.O.Box. No.26, Shobnall Road, Burton upon Trent, Staffordshire ("Marstons") and have been since 1984 the duly appointed Property Manager (now Group Property Manager)

2. Marstons are and have been since the 4th day of February 1971 the owner of the land known as the Royal Oak Church Street Kington in the County of Hereford and Worcester more particularly delineated on the plan accompanying this declaration and thereon edged red (marked "P.J.W.1")

3. By even date herewith I am depositing with the Hereford & Worcester County Council being the appropriate Council a statement accompanied by a plan delineating the property by red edging which states that no ways (and in particular the passage way coloured blue on the plan) have been dedicated as highways or footpaths over the said property

3916  
5584

4622  
1 0027a

4027  
2918a  
-72

4328  
1-5437a  
4-06

5133  
1-2647a  
3-42

6535  
3-2227a  
7-96

5743  
2-6687a  
2-22

4664  
65-6427a  
162-95

"P.J.W.1."

11,2500  
N

This is the plan marked  
"P.J.W.1." referred to in  
the Declaration of  
Phillip Joseph Webb.  
I declare before me,  
day of October 1957  
at St. Louis Mo.  
this day of October  
1957

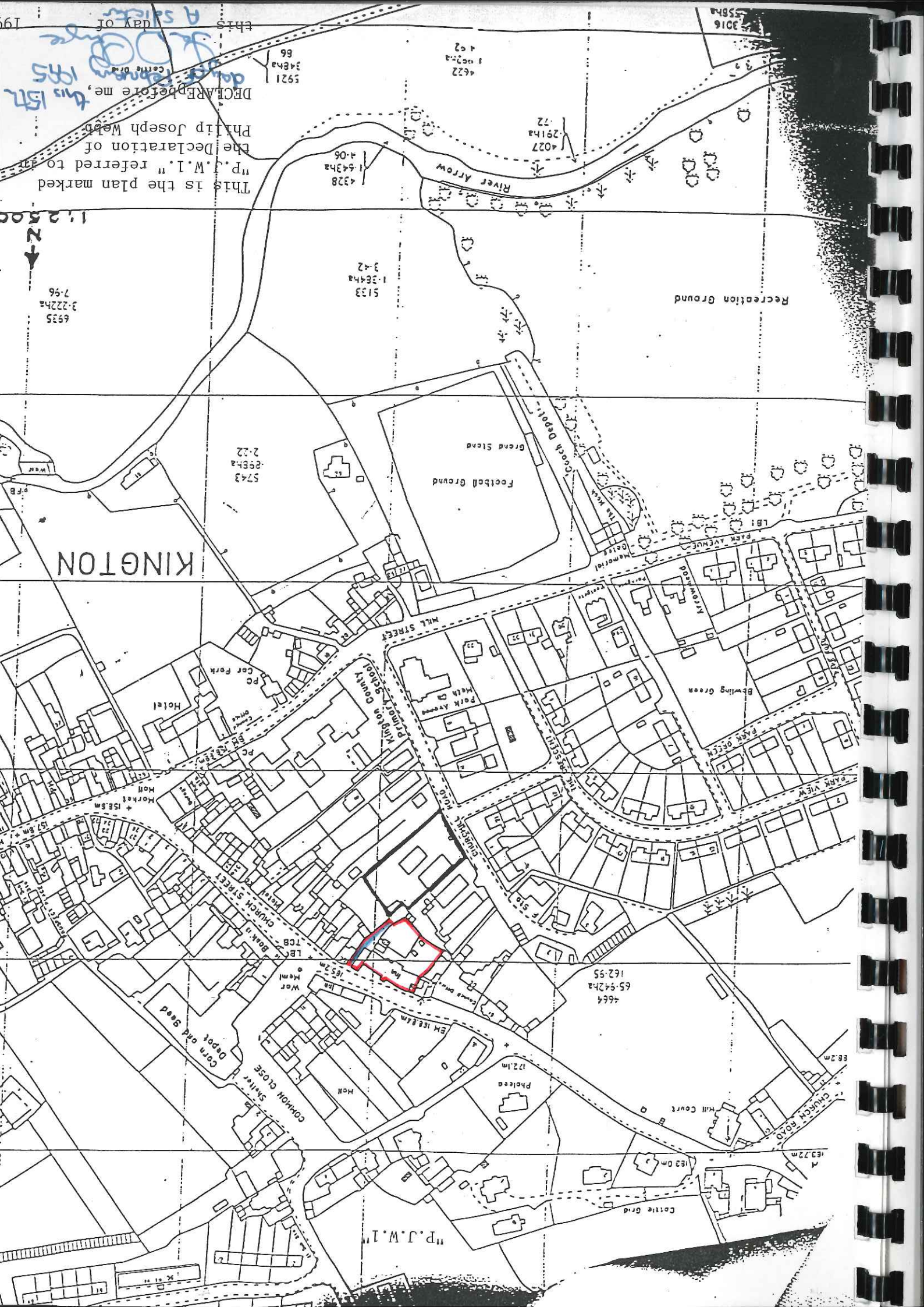

4. No additional ways have been dedicated over the land edged red either

by way of highway or footpath

AND I make this Solemn Declaration on the 15th day of February 1995 conscientiously believing the same to be true and by virtue of The Statutory

Declarations Act 1835

DECLARED at 24 Leinster Street  
Burlington Town  
in the County of Staffordshire



Before me,

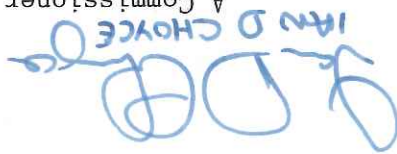

A Commissioner for Oaths