

4/64

To Hereford and Worcester County Council

STATEMENT PURSUANT TO SECTION 31, HIGHWAYS ACT 1980

LAND AT AMBERLEY COURT

I wish to deposit with Hereford and Worcester County Council the accompanying map on which the land I own is shown delineated in red.

I admit that the ways shown on the said map have been dedicated as highways.

This statement is made for the purposes of Section 31(b) of the Highways Act 1980.

Dated this 20 day of Sept. 1992

Signed

Colin Powell
Ms. Spaw



Received on behalf of the Hereford and Worcester County Council

..... *[Signature]*

Date *20/4/93*

Department of Engineering and Planning	
16 APR 1993	
For action	Copy for information
CEPO	
CP	
SJW	
SJ	
JR	<i>NF</i>
Consultant Services	
WDC	

Reproduced from the Ordnance Survey
with the permission of the Controller of Her Majesty's Stationery Office
© Crown Copyright
Hereford & Worcester County Council
County Hall, Spetchley Road
Worcester WR5 2NP
License No. LA0766

NOT
IN MY
ownership

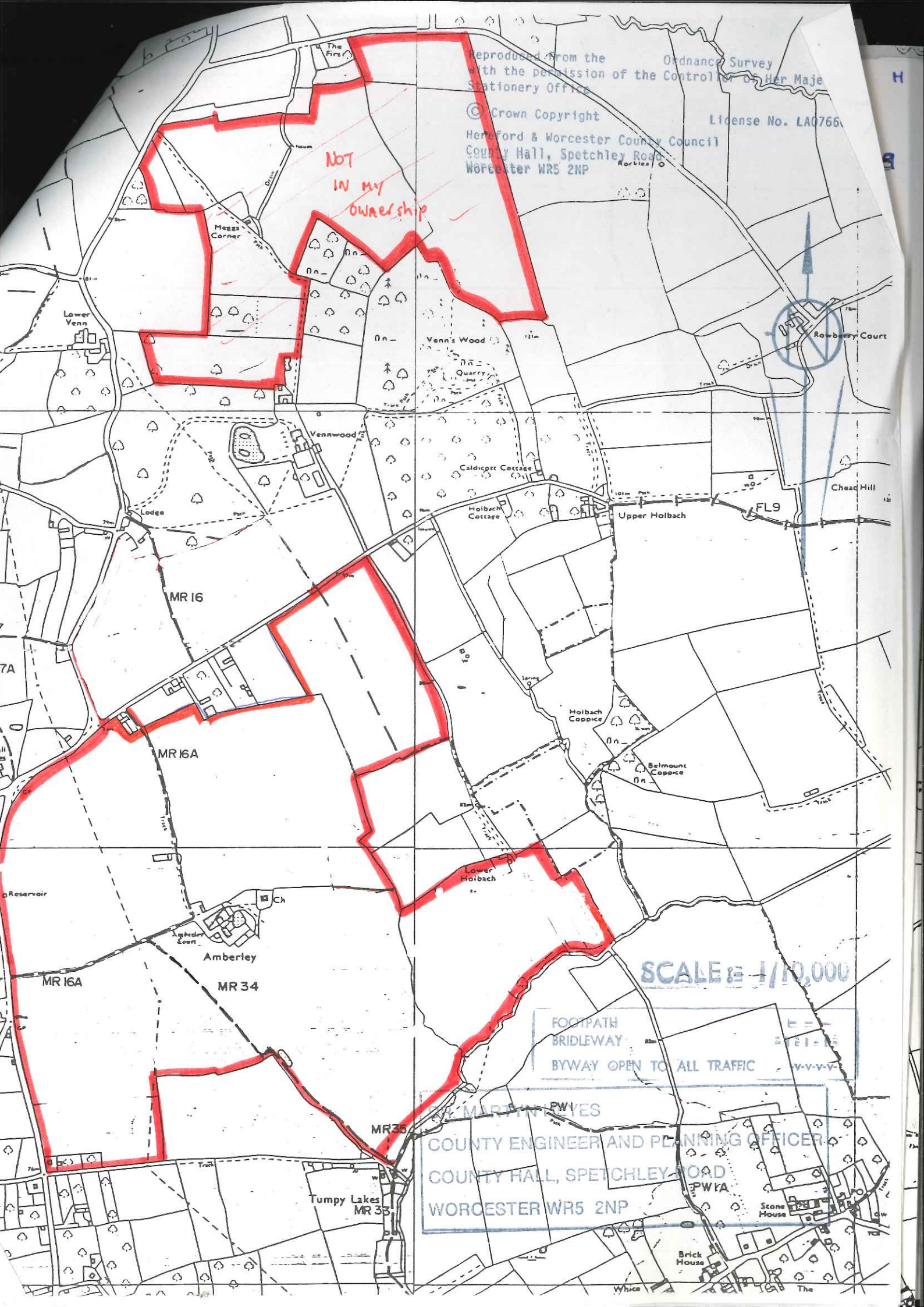
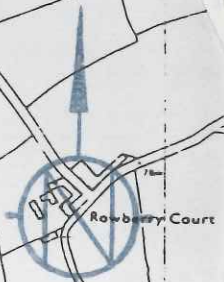

SCALE 1:10,000

FOOTPATH
BRIDLEWAY
BYWAY OPEN TO ALL TRAFFIC

MARTIN PYLES
COUNTY ENGINEER AND PLANNING OFFICER
COUNTY HALL, SPETCHLEY ROAD
WORCESTER WR5 2NP

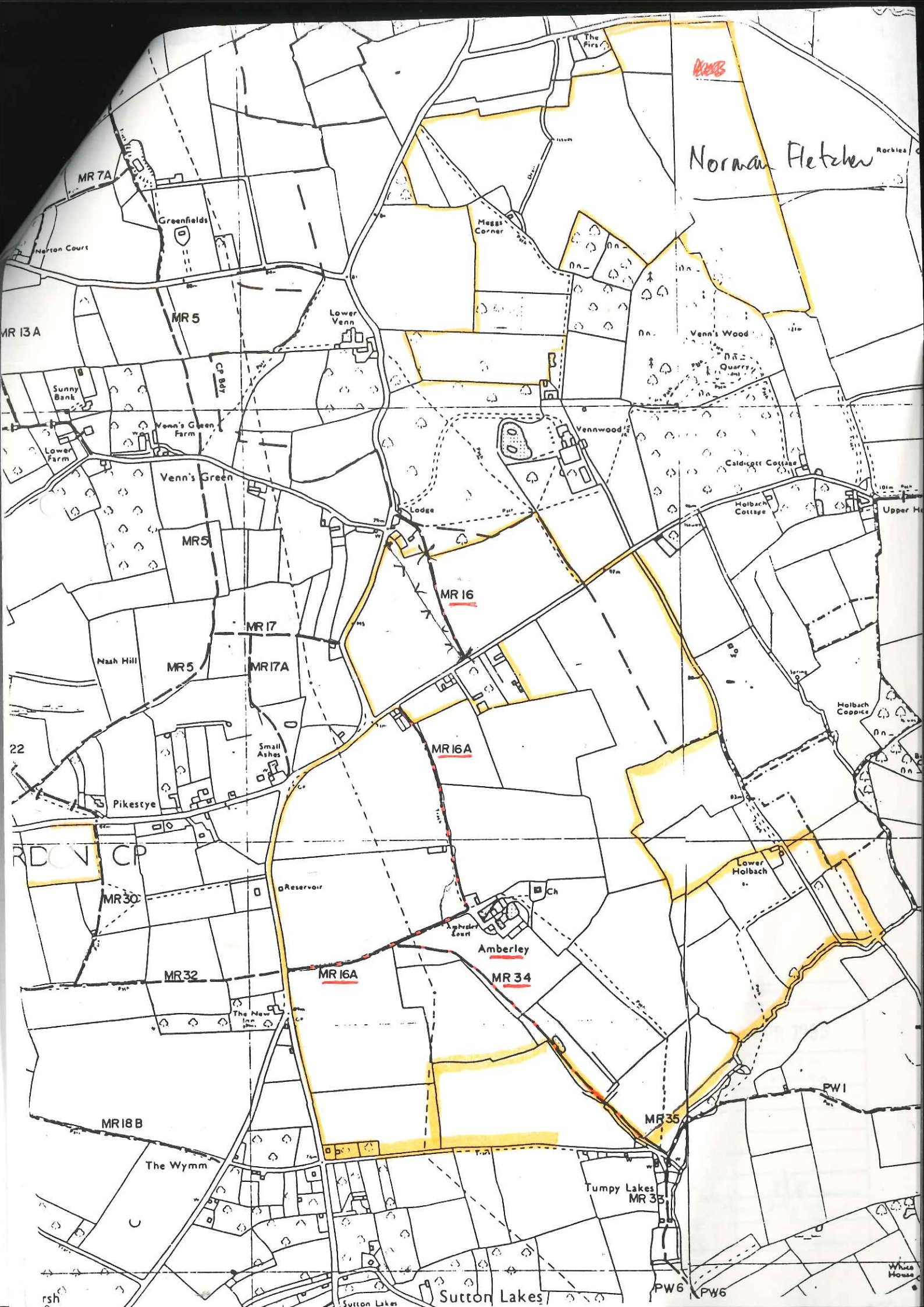

Norman Fletcher

B208

MR 7A

MR 5

MR 13A

Venn's Green

MRS

MR 17

Nash Hill

MR 5

MR 17A

MR 16

MR 16A

22

RDON CP

MR 30

MR 32

MR 16A

MR 34

MR 18B

The Wymm

MR 35

Tumpy Lakes
MR 35

Sutton Lakes

PW6

PW6

Whice House

Marden
Deposited 20.4.93
Renewal due 20.4.98

H

To Hereford and Worcester County Council

STATEMENT PURSUANT TO SECTION 31, HIGHWAYS ACT 1980

LAND AT AMBERLEY COURT

I wish to deposit with Hereford and Worcester County Council the accompanying map on which the land I own is shown delineated in red.

I admit that the ways shown on the said map have been dedicated as highways.

This statement is made for the purposes of Section 31(b) of the Highways Act 1980.

Dated this 20 day of Sept. 1992

Signed *Colin Powell*
Mrs. S. Powell .

Received on behalf of the Hereford and Worcester County Council

..... *[Signature]*

Date 20/4/93