

This site plan referred to in the  
declaration of Stephen Mitchell  
Turner the 12th day of August  
2005.

*See page*

*Solicitor.*

2003

3457

1555

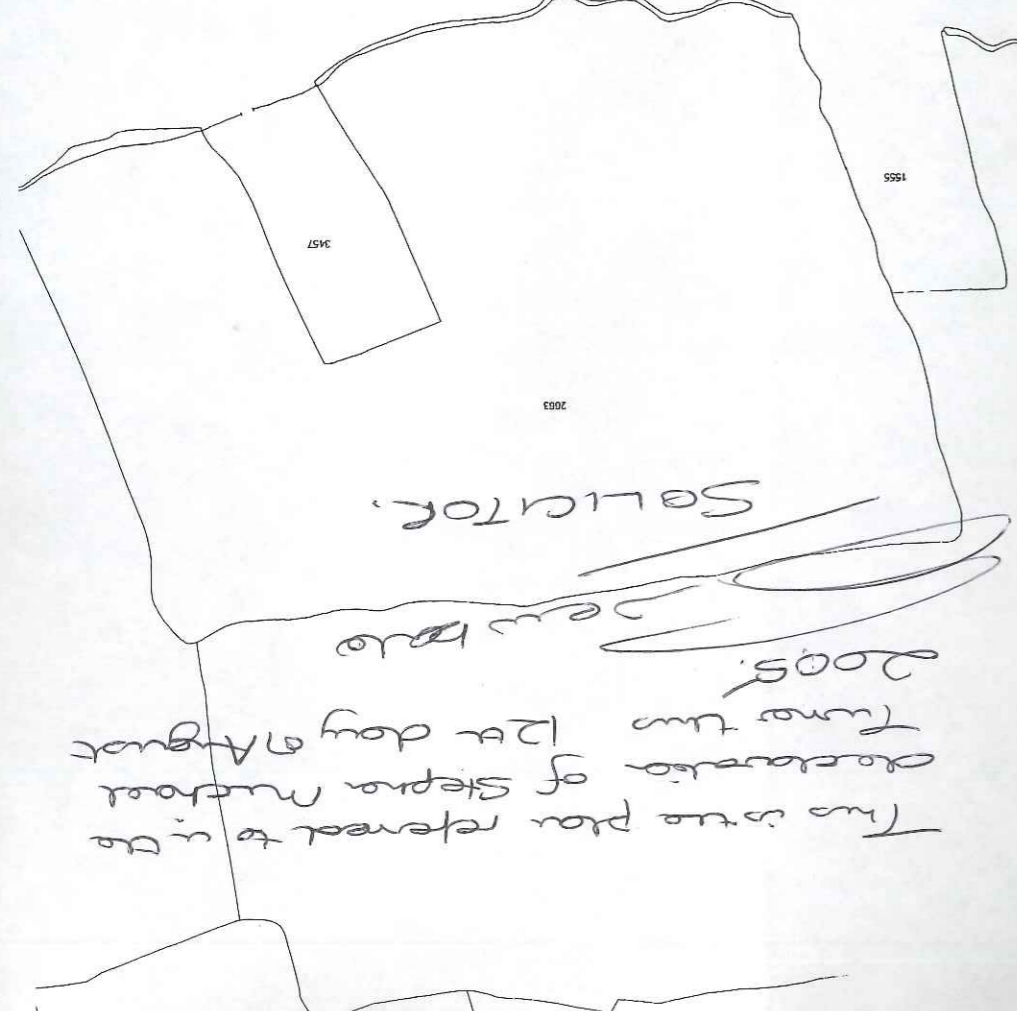

*The Underhills*

1030

9835

8134

8518

7048

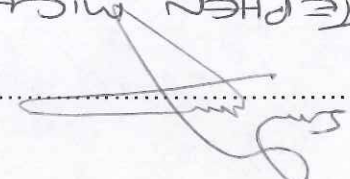

.....  
.....  
.....

Name: STEPHEN MICHAEL TURNER  
Signed: 

On the 12th day of August 2005 I wish to deposit with the County of Herefordshire District Council, a statement accompanied by a plan delineating my property by red edging which states that the ways coloured brown on the said plan and the plan accompanying this declaration have been dedicated as highways with vehicular status, the ways coloured green on the said plan and on the plan accompanying this declaration have been dedicated as bridleways; the ways coloured purple on the said plan and on the plan accompanying this declaration have been dedicated as highways over the property.



STATEMENT PURSUANT TO SECTION 31(6) HIGHWAYS ACT 1980

To: County of Herefordshire District Council





STATUTORY DECLARATION  
SECTION 31 (6) OF THE HIGHWAYS ACT 1980

I (landowner) Stephen Turner DO SOLEMNLY AND SINCERELY DECLARE as follows:

1. I am and have been since (day, month, year) 5th July, 2005 the owner of the land known as (name of farm, etc) The Ussell's, Much Birch. more particularly delineated on the plan accompanying this declaration and thereon edged red.

2. On the (day) 12th day of (month/year) August, 2005 I (or my predecessor in title (name) Stephen Turner) deposited with the County of Herefordshire District Council, a statement accompanied by a plan delineating my property by red edging which stated that the ways coloured brown on the said plan and on the plan accompanying this declaration had been dedicated as highways with vehicular status, [the ways coloured green on the said plan and on the plan accompanying this declaration had been dedicated as bridleways]; the ways coloured purple on the said plan and on the plan accompanying this declaration had been dedicated as bridleways; the ways coloured purple on the said plan and on the plan accompanying this declaration had been dedicated as highways with vehicular status]; [footpaths]; [no other ways had been dedicated as highways over my property].

3. \* On the (day) 12th day of (month, year) August 2005 I (or my predecessor in title (name) Stephen Turner) deposited with the County of Herefordshire District Council, being the appropriate Council, a statutory declaration dated (day, month, year) 12th August 2005 stating that no additional ways other than those marked in the appropriate colour on the plan accompanying this declaration] had been dedicated as highways with vehicular status]; [footpaths]; since the deposit of the Statement referred to in 2 above.

4. \*\* No additional ways have been dedicated over the land edged red on the plan accompanying this declaration since the statement dated (day, month, year) 12th August 2005 referred to in 2 above / since the date of the statutory declaration referred to in 3 above / other than those highways with vehicular status]; (bridleways) (footpaths) marked in the appropriate colour on the plan accompanying this declaration]

\* Delete paragraph 3 if submitting Statement and Statutory Declaration, of Section 31(6) Highways Act 1980 at the same time.  
\*\* Delete paragraph 4 if this is the first Statement and Statutory Declaration, of Section 31(6) Highways Act 1980.

AND I MAKE this solemn declaration on the (day) 12th day of (month, year) August, 2005. conscientiously believing it to be true and by virtue of the Statutory Declarations Act 1835.

Declared at (address) 17 Broad Street  
Hereford  
HR4 9PP

Signature of landowner

Before me Verole  
Susan Newbold  
(Commissioner for Oaths or a Justice of the Peace or Solicitor)  
Solicitor