

Jewkesbury; Dame Sylvia Crowe, D.B.E.;  
Darling, C.B.E., M.C.; The Right Honourable Lord Denning;  
Esq., O.B.E.; R. Hammond Innes Esq., C.B.E.;  
Esq.; Dame Moura Lympany, D.B.E.;  
Esq., C.B., C.V.O.  
Management:  
O.B.E. (Founder and President);  
Esq., F.C.A. (Chairman);  
Esq., A.R.I.C.S., A.L.I.; R. H. Trafford, M.A.;  
Esq., F.C.C.A.; T. H. White, F.R.I.C.S.;  
Esq., B.Sc. (For.), Ph.D.; D. H. Marks, M.I.P.A.;  
Esq., F.C.A., A.T.I.I.



Chief Executive: John D. James

**The Woodland Trust**  
Autumn Park, Dysart Road,  
Grantham, Lincolnshire NG31 6LL  
Telephone (0476) 74297  
Fax: (0476) 590808

Rights of Way Officer  
Hereford & Worcester County Council  
County Hall  
Spetchley Road  
Worcester

Our Ref: LHJ/pcj/680

10 August 1994

Dear Sir

The Woodland Trust, a company limited by guarantee and registered charity no: 294344, of Autumn Park, Dysart Road, Grantham, Lincolnshire, freehold owners of the property known as Folly's Lane, luston, Nr Leominster, Staffordshire which is shown highlighted in red on the attached plan, hereby gives notice in accordance with the Section 31(6) of the Highways Act 1980 that there are no ways over the land shown highlighted on the attached plan as being owned by the Woodland Trust which have been dedicated as a public highway.

Yours faithfully

Laura Judson (Miss)  
Legal Administrator authorised to sign on behalf of the  
Woodland Trust

Enc

Métres

41

39

38

37

36

264

F B

Louisa

4107  
2.39

4200  
1.28

4200  
.660ha  
1.63

4191  
1.210ha  
2.99

4186  
.737ha  
1.82

4280  
2.053ha  
5.07

4470  
1.725ha  
4.26

4861  
.202ha  
.50

4454  
2.300ha  
5.68

0001  
5.37

{ 0001  
.109ha  
.27

74  
na  
2

{ 0089  
.016ha  
.04

Annexy 0087  
.202ha  
.50

0083  
.405ha  
1.00

74  
36ha  
.40

{ 0164  
.061ha  
.15

0052  
.753ha

1900  
1.82

1900  
.441ha  
1.09

2900  
3.30

2900  
.712ha  
1.76

4200  
1.28

4200  
.660ha  
1.63

2493  
.393ha  
.97

1190  
1.477ha  
3.65

2589  
.554ha  
1.37

2685  
.376ha  
.93

1782  
.425ha  
1.05

The Folly

Elmshade

2780  
.737ha  
1.82

1976  
.870ha  
2.15

2775  
.393ha  
.97

The Ponderosa

3074  
.065ha  
.16

2371  
.732ha  
1.81

Pond

2166  
.793ha  
1.96

Rose Neath

3267  
.251ha  
.62

3465  
.154ha  
.38

2064  
.239ha  
.59

Track

3863  
.069ha  
.17

The Whym

2657  
2.878ha  
7.11

1054  
1.984ha  
4.90

Pond

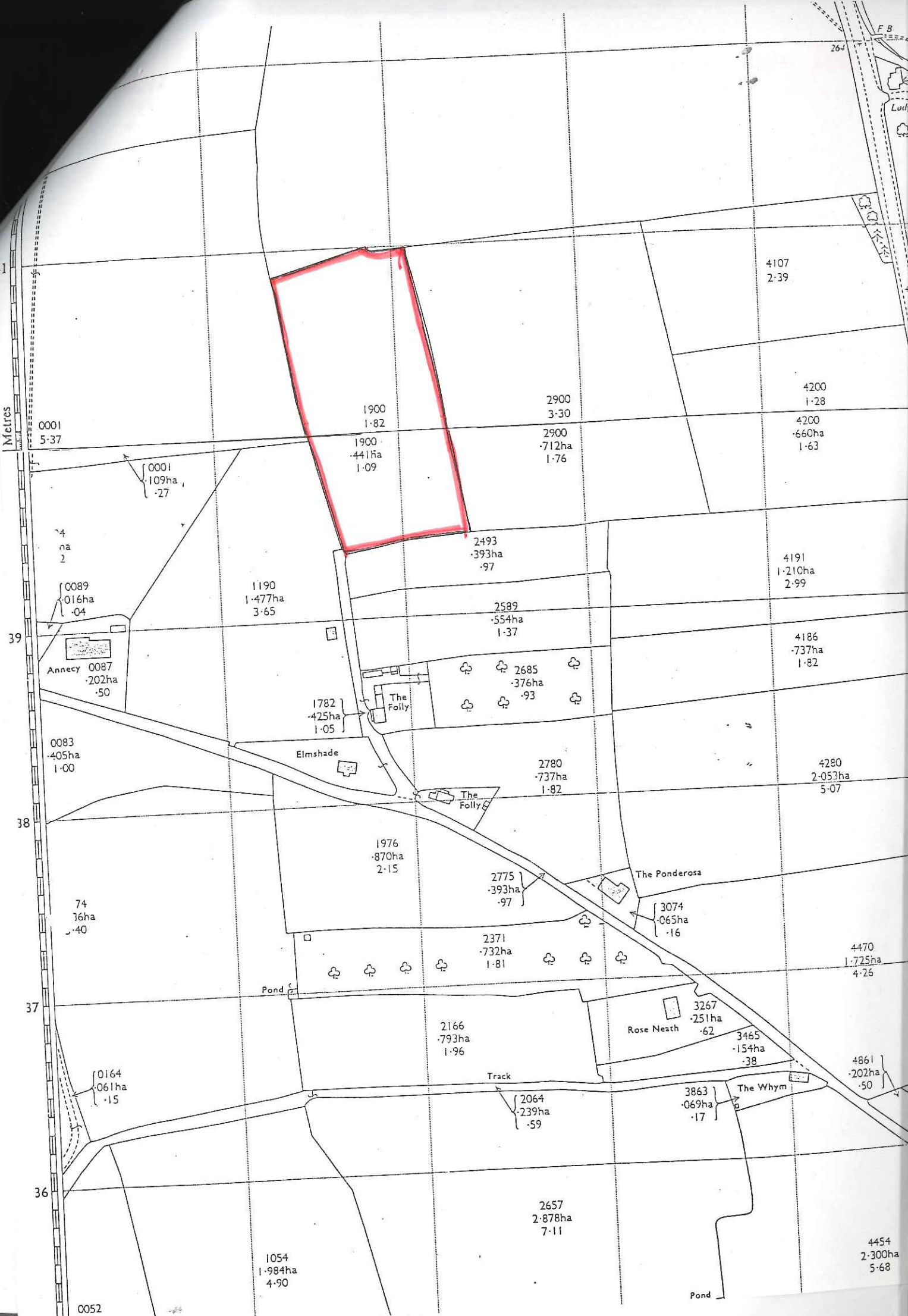
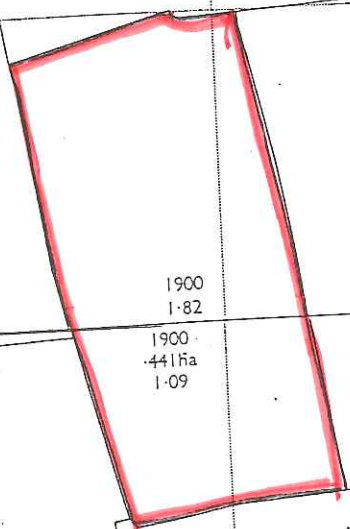



Produced 03 Jul 2001 from Ordnance Survey digital data and incorporating surveyed revision available at this date.

© Crown Copyright

2001

This product contains data surveyed or more of the following scales: 1/12500 & 1/10000. 100

Reproduction in whole or in part is prohibited without the prior permission of Ordnance Survey.

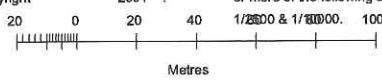

Ordnance Survey and Superplan Data are registered trade marks of Ordnance Survey the national mapping agency of Great Britain

National Grid sheet reference at centre of this Superplan:

The representation of a road, track or path is no evidence of a right of way

Folly's Lane	
<p><b>WOODLAND TRUST</b></p>	Wood No: <i>[Signature]</i>
	Cost Centre: <i>[Signature]</i>
	Scale: 1:2500
	Author: LS
	Date: 11/01/02
Reproduced from Ordnance Survey digital data © Crown Copyright. AL559385	



The Woodland Trust

Autumn Park  
Dysart Road  
Grantham  
Lincolnshire  
NG31 6LL

Telephone  
01476 581111  
Facsimile  
01476 590808  
Website  
[www.woodland-trust.org.uk](http://www.woodland-trust.org.uk)

Engineering Services  
Herefordshire District Council  
Po Box 34  
Hereford  
HR1 2ZD

Our Ref: LJS/ljs/00684

18 January 2002

Dear Sir

**DEPOSIT OF STATEMENT AND PLAN**  
**HIGHWAYS ACT 1980 SECTION 31(6)**

We, the Woodland Trust, a company limited by guarantee and registered charity no: 194344, of Autumn Park, Dysart Road, Grantham, Lincolnshire, have been since 27 July 1994 the owner within the meaning of the above section of the land known as Folly's Lane, Luston, Worcester more particularly delineated on the plan accompanying this statement and thereon edged red.

No ways over the land have been dedicated as highways.

At the present time we have no intention of dedicating any public rights of way over our property.

The deposit comprises this statement and the accompanying plan.

Yours faithfully

Miss Louise Smith  
Assistant Land Agent authorised to sign on behalf of the Woodland Trust

Enc.

MKE

The Woodland Trust

Autumn Park  
Dysart Road  
Grantham  
Lincolnshire  
NG31 6LL

Telephone  
01476 581111  
Facsimile  
01476 590808  
Website

[www.woodland-trust.org.uk](http://www.woodland-trust.org.uk)

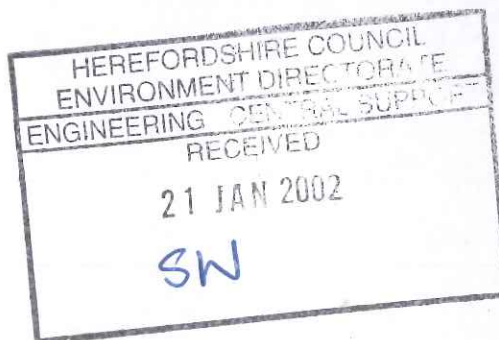

Engineering Services  
Herefordshire District Council  
Po Box 34  
Hereford  
HR1 2ZD

Our Ref: LJS/ljs/00684

18 January 2002

Dear Sir

**Highways Act 1980 - Section 31 (6)**  
**Folly's Lane, Luston, Worcester**  
**OS No. 149 Grid Reference SO481640**

The Woodland Trust previously gave notice on 10 August 1994, as required by the above Act, declaring that no ways are known to be public highways over the above property. It had been the Trust's aim to confirm its intention not to dedicate public highways over its property by depositing a Statutory Declaration to this effect within six years of the above date.

The Trust has continued to manage its property with this intention, but the six year period for submission of a Statutory Declaration has now elapsed, and the Trust is therefore resubmitting the attached notice. A Statutory Declaration will be deposited in accordance with the Highways Act procedure, within six years from today's date.

I would welcome any comments which you wish to make on this letter and enclosures.

Please acknowledge acceptance of the formal notice.

Yours faithfully

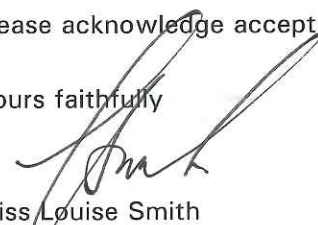
  
Miss Louise Smith  
Assistant Land Agent

Enc.



STATUTORY DECLARATION

HIGHWAYS ACT 1980 SECTION 31 (6)

I AVERIL HAROLD DO SOLEMNLY AND SINCERELY DECLARE as follows:

1. The Woodland Trust, a company limited by guarantee and registered charity no. 294344, is and has been since 27 July 1994 the owner of the land known as Folly's Lane, Luston more particularly delineated on the plan accompanying this declaration and thereon edged red.
2. On the 18 January 2002 the Woodland Trust deposited with Herefordshire Council, being the appropriate Council, a statement accompanied by a plan delineating our property by red edging which stated that:
  - no ways had been dedicated as highways over our property.
3. No additional ways have been dedicated over the land edged red on the plan accompanying this declaration since the statement dated 18 January 2002 referred to in 2 above and at the present time the Woodland Trust has no intention of dedicating any more public rights of way over its property.

AND I MAKE this solemn declaration on the 28 day of June 2011 conscientiously believing it to be true and by virtue of the Statutory Declarations Act 1835.

**Declared at:** The Woodland Trust, Kempton Way, Grantham, Lincolnshire, NG31 6LL

Averil Harold (Mrs)   
Legal Officer authorised to sign on behalf of the Woodland Trust

Before me, Nicola Briggs, Solicitor, of Kingswell Watts, Solicitors, Dewsbury, West Yorkshire

