

Theresa Wilson
Rights of Way Technical Assistant
County Hall
WRS 2MP



To: Hereford and Worcester County Council

STATEMENT PURSUANT TO SECTION 31(6) HIGHWAYS ACT 1980

On the *8th* day of *January 1998* I wish to deposit with Hereford and Worcester County Council, being the appropriate Council, a statement accompanied by a plan delineating my property by red edging which states that the ways coloured brown on the said plan and the plan accompanying this declaration have been dedicated as highways with vehicular status, the ways coloured green on the said plan and on the plan accompanying this declaration have been dedicated as bridleways; the ways coloured purple on the said plan and on the plan accompanying this declaration have been dedicated footpaths; no other ways have been dedicated as highways over the property.

Signed

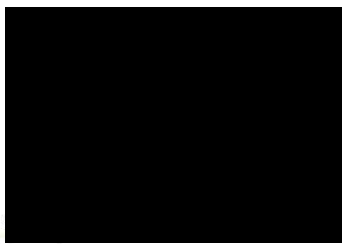

A-H-KARRIS

Environmental Services Department	
Ref No	<i>9 - JAN 1998</i>
File No	
Case No	
Sub No	
Doc No	
SI	

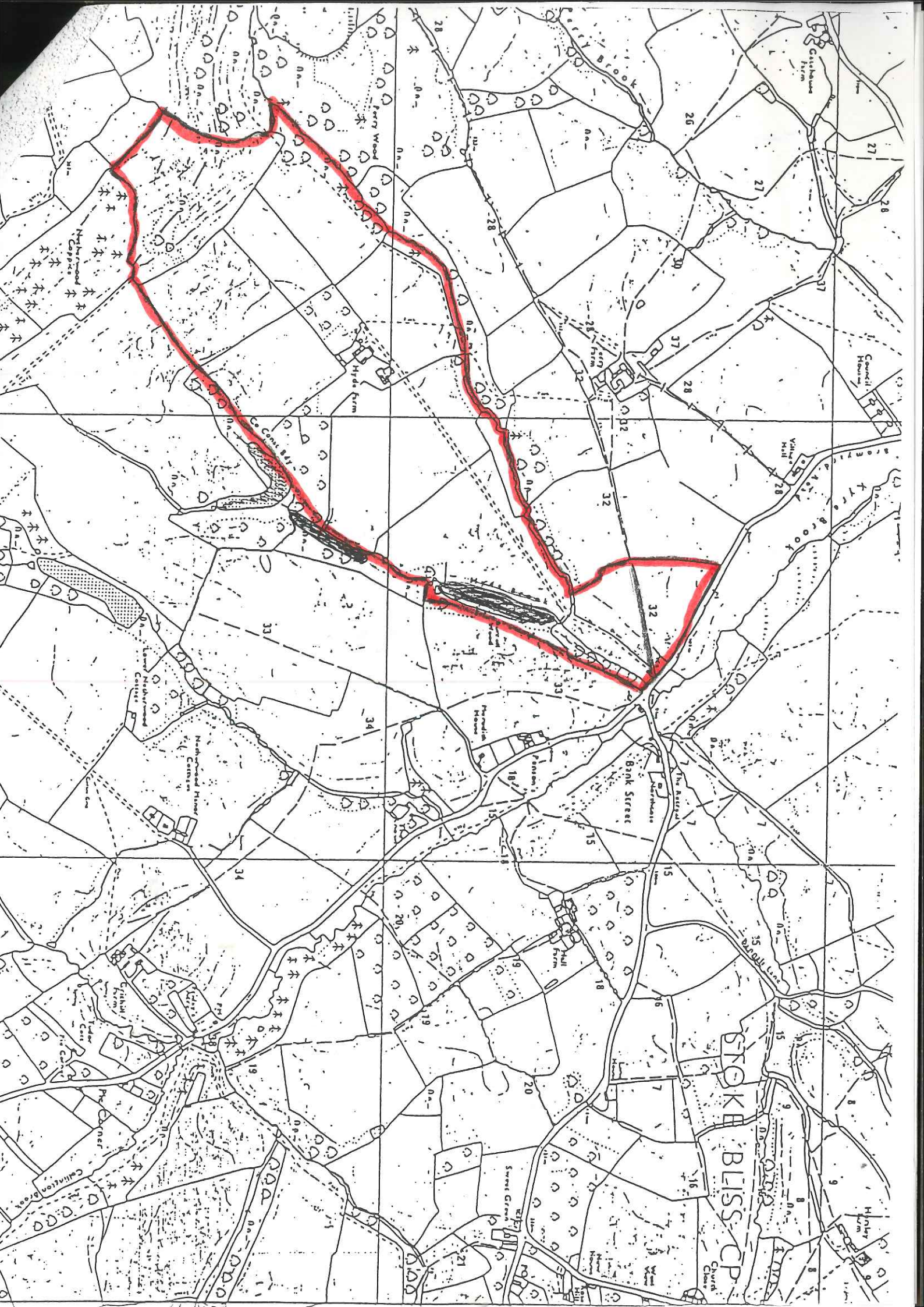

STOKE BLISS CP

Bank Street

Hyde Farm

Perry Wood

Co. Canal B.R.

Stoke Bliss CP

Stoke Bliss CP

Stoke Bliss CP