

QUARRY WOOD

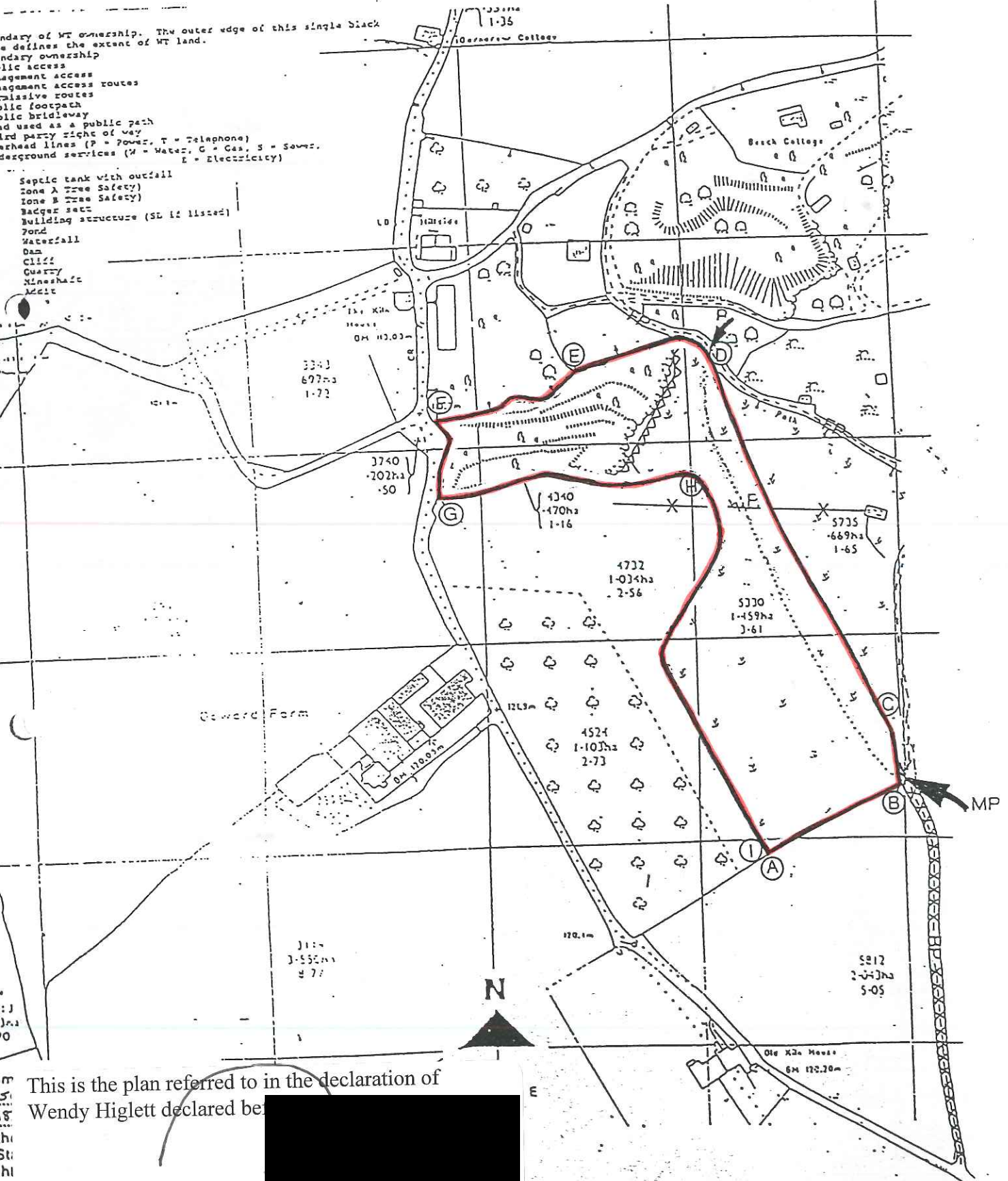

OS No. 162 ST 545163

The Woodland Trust
Autumn Park, Dysart Road,
Grantham, Lincolnshire NG31 6LL
Telephone (0476) 74297
Fax: (0476) 590808



Boundary of WT ownership. The outer edge of this single black line defines the extent of WT land.
Boundary ownership
Public access
Management access
Management access routes
Permissive routes
Public footpath
Public bridleway
Road used as a public path
Third party right of way
Overhead lines (P = Power, T = Telephone)
Subground services (W = Water, G = Gas, S = Sewer, E = Electricity)

Septic tank with outfall
Zone A Tree Safety
Zone B Tree Safety
Badger sett
Building structure (SD if listed)
Pond
Waterfall
Dam
Cliff
Quarry
Mineshaft
Mound

This is the plan referred to in the declaration of Wendy Higglett declared by [redacted]

1st DECEMBER 1997

STATUTORY DECLARATION

HIGHWAYS ACT 1980 SECTION 31 (6)

I WENDY HIGLETT DO SOLEMNLY AND SINCERELY DECLARE as follows:

1. The Woodland Trust, a company limited by guarantee and registered charity no. 294344, is and has been since 21st day of June 1991 the owner of the land known as Quarry Wood, Great Doward, near Whitchurch, more particularly delineated on the plan accompanying this declaration and thereon edged red.
2. On the 20th day of November 1997 I deposited with Hereford & Worcester County Council, being the appropriate Council, a statement accompanied by a plan delineating our property by red edging which stated that no ways had been dedicated as highways over our property.
3. No additional ways have been dedicated over the land edged red on the plan accompanying this declaration since the statement dated 20th November 1997 referred to in 2 above and at the present time the Woodland Trust has no intention of dedicating any more public rights of way over its property.

AND I MAKE this solemn declaration on the ^{15th} day of December, 1997 conscientiously believing it to be true and by virtue of the Statutory Declarations Act 1835.

Declared at: Mills & Reeve, Francis House, 112 Hills Road, Cambridge, CB2 1PH

.....
Wendy Higlett

Legal Administrator authorised to sign on behalf of the Woodland Trust

Before me, Glyn Jones, Commissioner for Oaths
.....

Patrons:

The Lord Barber of Tewkesbury; Dr J. Morton Boyd, C.B.E., FR.S.E.;
Sir James Stormonth Darling, C.B.E., M.C.; The Right Honourable Lord Denning;
P. F. Garthwaite Esq., O.B.E.; R. Hammond Innes Esq., C.B.E.;
The Earl of Lichfield; Dame Moura Lympany, D.B.E.;
E. M. Nicholson Esq., C.B., C.V.O.; The Marchioness of Dufferin and Ava

Council of Management:

T. H. White, FR.I.C.S. (Chairman);
C. P. Wright, M.Sc. A.R.I.C.S., A.L.L.; R. H. Trafford M.A.;
T. W. Wright, B.Sc. (For.), Ph.D.; A. P. Golding, F.C.A., A.T.I.L.;
D. V. Gaultier, C.B.E., M.A., B.L.; M. F. Barton, LL.B.,
P. J. Oliver F.C.A., A.T. Bigg, B.A.



Chief Executive: Michael J. Townsend

The Woodland Trust
Autumn Park, Dysart Road,
Grantham, Lincolnshire NG31 6LL
Telephone (01476) 581111
Fax: (01476) 590808

Environmental Services (PROW)
Hereford & Worcester County Council
County Hall
Spetchley Road
Worcester
WR5 1BR

Our Ref: WH/wh/0492

20 November 1997

Dear Sir

DEPOSIT OF STATEMENT AND PLAN
HIGHWAYS ACT 1980 SECTION 31(6)

We, the Woodland Trust, a company limited by guarantee and registered charity no: 194344, of Autumn Park, Dysart Road, Grantham, Lincolnshire, have been since 21st June 1991 the owner within the meaning of the above section of the land known as Quarry Wood, Great Doward, near Whitchurch, Hereford & Worcester, more particularly delineated on the plan accompanying this statement and thereon edged red.

No ways over the land have been dedicated as highways.

At the present time we have no intention of dedicating any public rights of way over our property.

The deposit comprises this statement and the accompanying plan.

Yours faithfully

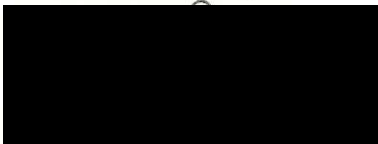

Wendy Higlett

Legal Administrator authorised to sign on behalf of the Woodland Trust

Enc.

STATUTORY DECLARATION

HIGHWAYS ACT 1980 SECTION 31 (6)

I SARAH PRIESTMAN DO SOLEMNLY AND SINCERELY DECLARE as follows:

1. The Woodland Trust, a company limited by guarantee and registered charity no. 294344, is and has been since 21 June 1991 the owner of the land known as Quarry Wood, Wyastone Leys, Great Doward near Whitchurch, Herefordshire more particularly delineated on the plan accompanying this declaration and thereon edged red.
2. On the 20 of November 1997 the Woodland Trust deposited with Herefordshire Council, being the appropriate Council, a statement accompanied by a plan delineating our property by red edging which stated that no ways had been dedicated as highways over our property.
3. On the 1 day of December 1997 my predecessor in title Laura Judson deposited with Herefordshire Council, being the appropriate Council, a statutory declaration dated 1 December 1997 stating that no additional ways had been dedicated since the deposit of the statement referred to in 2 above.
4. No additional ways have been dedicated over the land edged red on the plan accompanying this declaration since the date of the statutory declaration referred to in 3 above and at the present time the Woodland Trust has no intention of dedicating any more public rights of way over its property.

AND I MAKE this solemn declaration on the 24 day of September, 2003 conscientiously believing it to be true and by virtue of the Statutory Declarations Act 1835.

Declared at: The Woodland Trust, Autumn Park, Dysart Road, Grantham, Lincolnshire, NG31 6LL

.....
Sarah Priestman

Trainee Land Agent authorised to sign on behalf of the Woodland Trust

Before me, Nicola Briggs, Solicitor, of Jordans Solicitors, Dewsbury, West Yorkshire

.....
[Redacted Signature]

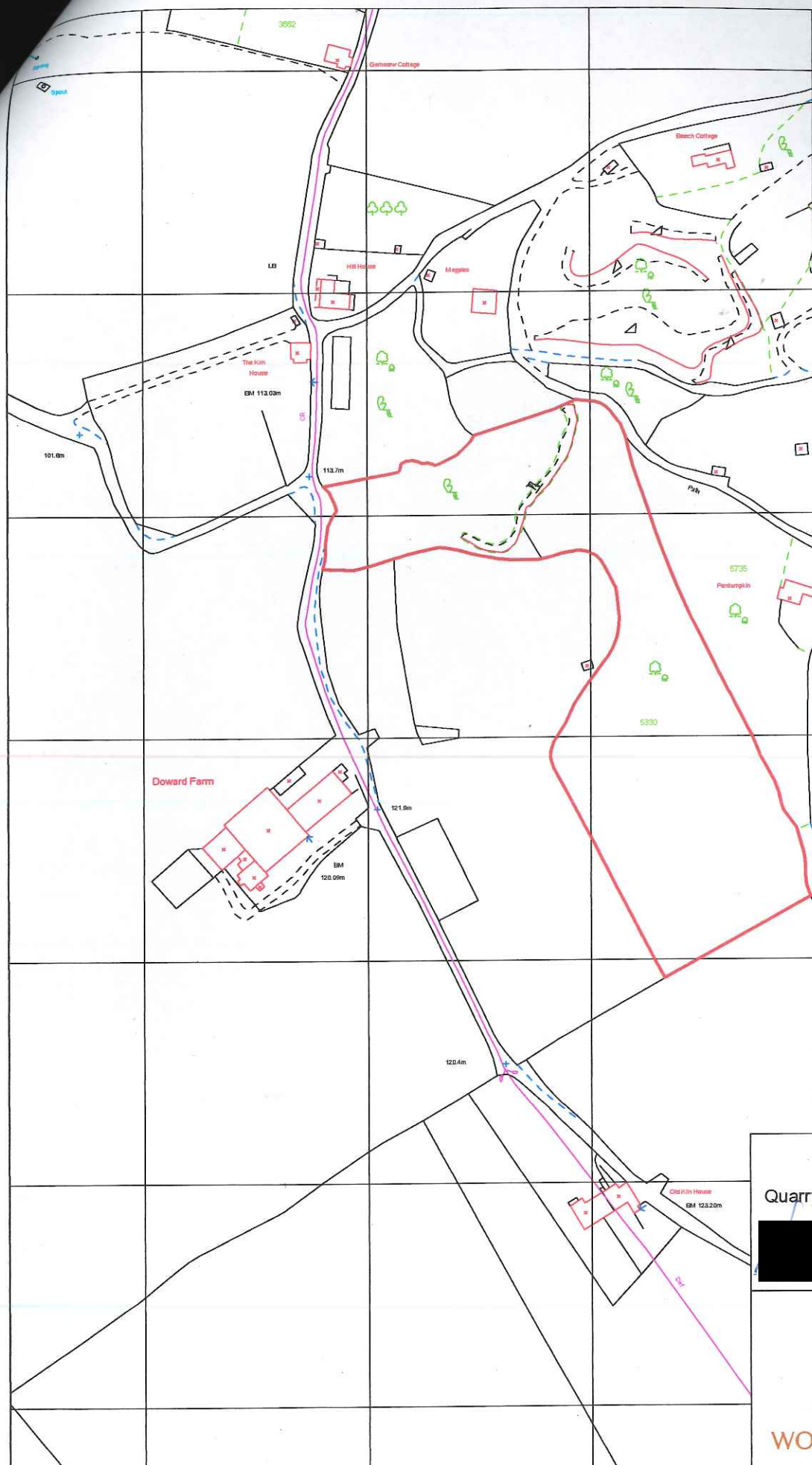







Quarry Wood

Wood No: 00492
 Cost Centre: 00492
 Map Ref:
 Scale: 1:2500
 Author: SP
 Date: 02/09/2003

Reproduced from Ordnance Survey 1:2500 digital data
 © Crown Copyright. AL100017626



Statutory Declaration Legend

-  Woodland Trust Boundary
-  Footpath
-  Bridleway
-  Byway Open to All Traffic
-  Restricted Byway
-  Other legal route

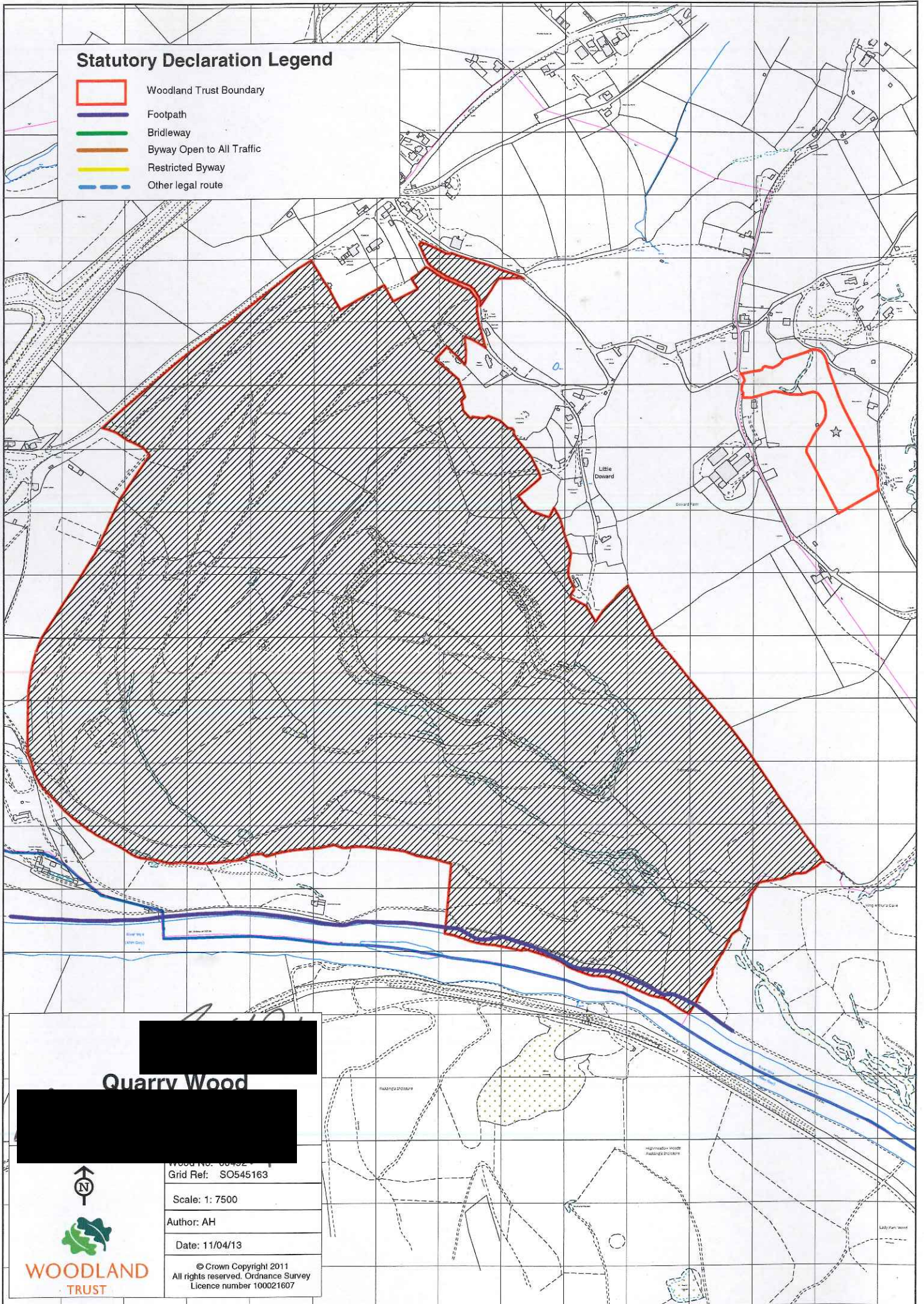

Quarry Wood



WOODLAND TRUST

Grid Ref: SO545163

Scale: 1: 7500

Author: AH

Date: 11/04/13

© Crown Copyright 2011
All rights reserved. Ordnance Survey
Licence number 100021607

STATUTORY DECLARATION

HIGHWAYS ACT 1980 SECTION 31 (6)

I AVERIL HAROLD DO SOLEMNLY AND SINCERELY DECLARE as follows:

1. The Woodland Trust, a company limited by guarantee and registered charity no. 294344, is and has been since 21 June 1991 the owner of the land known as Quarry Wood, Wyastone Leys more particularly delineated as the unhatched area on the plan accompanying this declaration and thereon edged red.
2. On the 24 September 2003 the Woodland Trust deposited with Herefordshire County Council, being the appropriate Council, a statutory declaration stating that no additional way had been dedicated since the deposit of the statement 20 November 1997
3. No additional ways have been dedicated over the land edged red on the plan accompanying this declaration since the statutory declaration referred to in 2 above and at the present time the Woodland Trust has no intention of dedicating any more public rights of way over its property.

AND I MAKE this solemn declaration on the 30th day of May 2013 conscientiously believing it to be true and by virtue of the Statutory Declarations Act 1835.

Declared at: The Woodland Trust, Kempton Way, Grantham, Lincolnshire, NG31 6LL

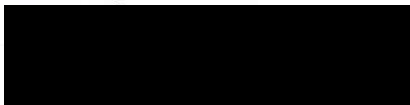

Averil Harold (Mrs)
Legal Officer authorised to sign on behalf of the Woodland Trust

Before me, Nicola Briggs, Solicitor, of Messrs Hellewell Pasley & Brewer 66/68
Daisy Hill Dewsbury West Yorkshire WF13 1LS

