



HEREFORDSHIRE
COUNCIL

To: County of Herefordshire District Council

STATEMENT PURSUANT TO SECTION 31(6) HIGHWAYS ACT 1980

On the 2ND day of July, 2008 I wish to deposit with the County of Herefordshire District Council, being the appropriate Council, a statement accompanied by a plan delineating my property by red edging which states that the ways coloured brown on the said plan and the plan accompanying this declaration have been dedicated as highways with vehicular status, the ways coloured green on the said plan and on the plan accompanying this declaration have been dedicated as bridleways; the ways coloured purple on the said plan and on the plan accompanying this declaration have been dedicated as footpaths; no other ways have been dedicated as highways over the property.

Signed:

Name:

LADY MERIEL DARBY

CROFT LODGE

BIRCHER, LEOMINSTER

HEREFORDSHIRE

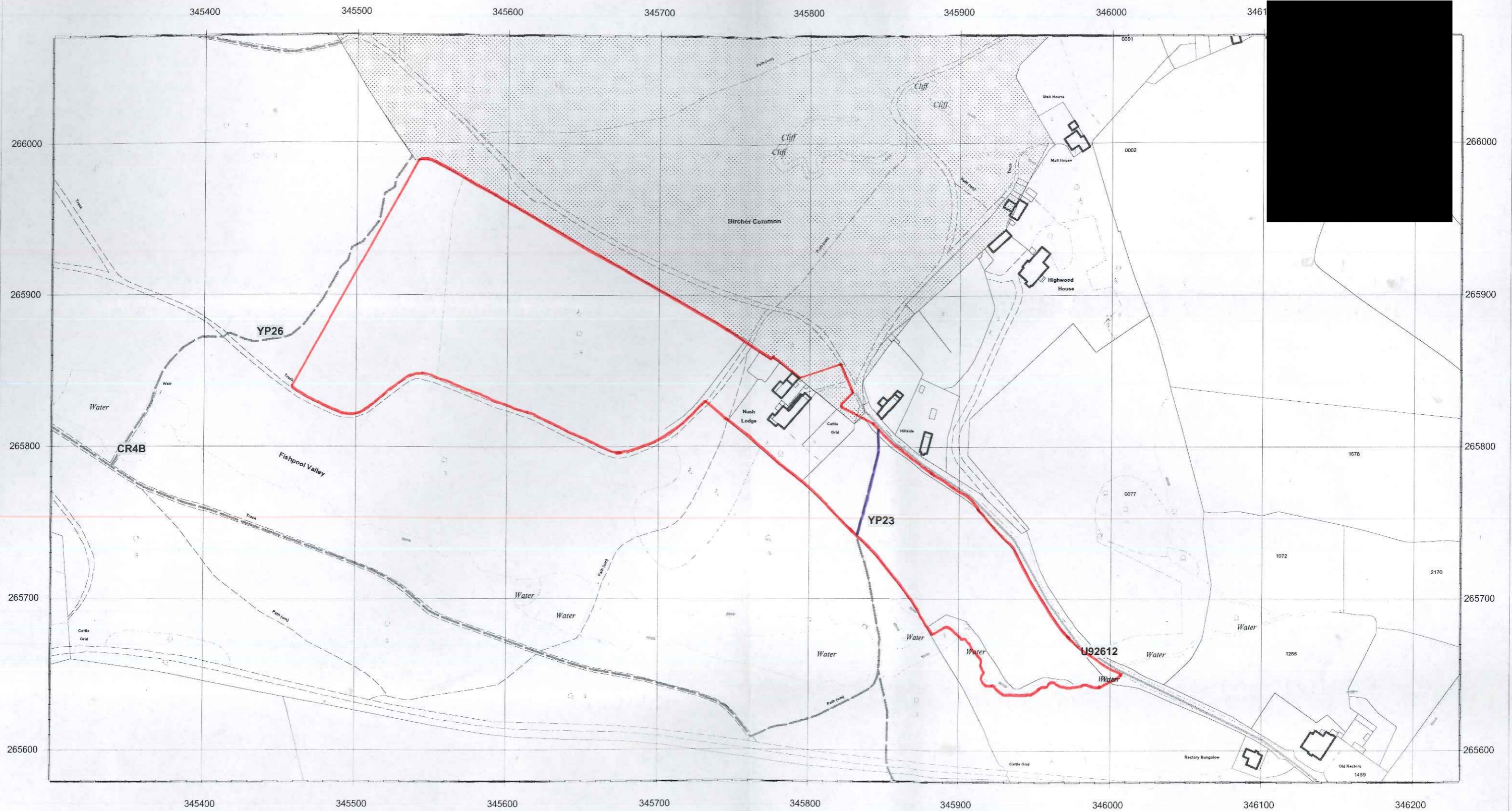

LOCATION PLAN - Land surrounding Croft Lodge, Bircher
Leominster

SCALE 1:2500



Reproduced from Ordnance Survey mapping with the permission of the Controller of Her Majesty's Stationery Office. Crown Copyright. Unauthorised reproduction infringes Crown copyright and may lead to prosecution or civil proceedings. 100024168. 2004.
This information is based on that currently available to the County of Herefordshire District Council from the Definitive map and Statement and other public records. It is given on the strict understanding that neither the Council nor any of its officers will be responsible for the accuracy of this information or accept any liability whatsoever for any error or omission therein for any loss or damage arising from interpretation or use of the information supplied. The inquirer should rely on the results of their own investigations.

- PUBLIC FOOTPATH
- PUBLIC BRIDLEWAY
- BYWAY OPEN TO ALL TRAFFIC

Herefordshire Council
Public Rights of Way
PO Box 41
Leominster
HR6 02A
Tel.: (01432) 260000
Fax.: (01432) 260526



HEREFORDSHIRE COUNCIL

STATUTORY DECLARATION SECTION 31 (6) OF THE HIGHWAYS ACT 1980

Meriel Kathleen Darby of 12000 Craft Lodge, Dorken Herefordshire I (landowner) DO SOLEMNLY AND SINCERELY DECLARE as follows:

1. I am and have been since (day, month, year) 18th December 2006 the owner of the land known as (name of farm, etc) Craft Lodge, Dorken, Herefordshire more particularly delineated on the plan accompanying this declaration and thereon edged red.

2. On the (day) 2nd day of (month, year) July 2008 I (or my predecessor in title (name)) deposited with the County of Herefordshire District Council, being the appropriate Council, a statement accompanied by a plan delineating my property by red edging which stated that [the ways coloured brown on the said plan and on the plan accompanying this declaration had been dedicated as highways with vehicular status]; [the ways coloured green on the said plan and on the plan accompanying this declaration had been dedicated as bridleways]; [the ways coloured purple on the said plan and on the plan accompanying this declaration had been dedicated as footpaths]; [no [other] ways had been dedicated as highways over my property].

3.* On the (day) day of (month, year) I (or my predecessor in title (name)) deposited with the County of Herefordshire District Council, being the appropriate Council, a statutory declaration dated (day, month, year) stating that no additional ways [other than those marked in the appropriate colour on the plan accompanying this declaration] had been dedicated as [highways with vehicular status] [bridleways] [footpaths] since the deposit of the Statement referred to in 2 above.

4.** No additional ways have been dedicated over the land edged red on the plan accompanying this declaration since the statement dated (day, month, year) referred to in 2 above [since the date of the statutory declaration referred to in 3 above] [other than those (highways with vehicular status) (bridleways) (footpaths) marked in the appropriate colour on the plan accompanying this declaration]

* Delete paragraph 3 if submitting Statement and Statutory Declaration, of Section 31(6) Highways Act 1980 at the same time.
** Delete paragraph 4 if this is the first Statement and Statutory Declaration, of Section 31(6) Highways Act 1980.

AND I MAKE this solemn declaration on the (day) 2nd day of (month, year) July 2008 conscientiously believing it to be true and by virtue of the Statutory Declarations Act 1835.

Declared at (address) 17, High Street Dorken Herefordshire Signature of landowner

Before me (Commissioner for Oaths or a Justice of the Peace or Solicitor) DAVID C. GREER Solicitor

Thomson & Bancks LLP SOLICITORS 37 High Street Pershore Worcestershire WR10 1AH