

Reproduced from the Ordnance Survey Map with the permission of the Controller of H.M. Stationery Office. Crown Copyright reserved. Licence No.100018318

Scale 1:10000

NOTES

- Historic flood map
- Area benefiting from flood defences
- Greater than 0.1% flood risk from river / sea (floodzone 2)
- Greater than 1.0% flood risk from river or 0.5% flood risk from sea (floodzone 3)
- Source Protection Zone 1 (inner zone)
- Source Protection Zone 2 (outer zone)
- Source Protection Zone 3 (total catchment)
- Flood defences
- Surface Water Course (with flow direction)

Other designations

- Archaeology
- Ancient Woodland
- Special Area of Conservation (SAC)
- Site of Special Scientific Interest (SSSI)
- Conservation Areas
- Special Wildlife Site (SWS)
- Ancient Monument
- Historic Parks and Gardens
- UDP Proposed Housing Site
- Land Use (as annotated)
- Listed building
- Roundabout
- Severance
- Bridge
- Culvert
- Proposed Traffic Signals

Legend

- E-On 11kv PVC Cable
- E-On 66kv Undergrnd Cable
- E-On LV Overhead Cable
- Gas - LHP Mains
- CS - WW - Combined Sewerage
- WW - Existing Trunk Water Main
- WW - Existing Water Main
- WW - Foul Sewerage
- Gas LP - LP Mains
- Gas LP - MP Mains
- Gas LP - Pumped Foul Sewerage
- BT u/g
- BT Overhead

Rev	Listed Buildings Added	SD	RM	21/09/10
A				
Rev	Revision details	Chkd	Appd	Date

Drawn: MG	Preliminary	✓
Design: DK	For comment	
Chkd: SD	For tender	
Appd: RM	For construction	
Date: Sept 2010	As constructed	
	Other	

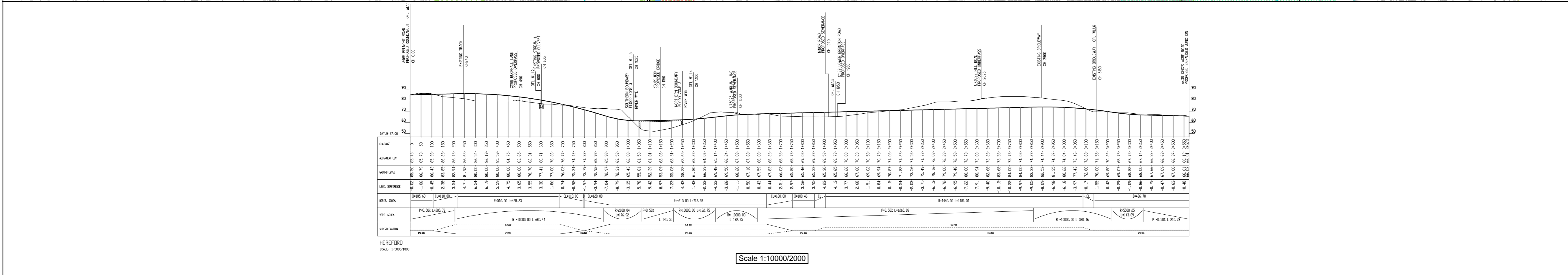

Scale 1:10000/2000

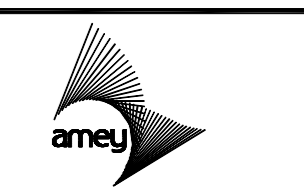

Client
M. HAIGE
 DIRECTOR OF ENVIRONMENT & CULTURE
Herefordshire Council

Brookington, 35 Halford Road, Hereford, HR1 1SH Tel: (01432) 260780 Fax: (01432) 261983

Project Name
 Herford Relief Road

Drawing Title
 Western Link 1
 Sheet 3 of 32

Original Drawing Size :	A3	
Scale :	1:10000	
Dimensions :	Metres	
Drawing No	Map No	Rev
551497-H-P-A3.03	A3.03	A