

File: n:\projects\09-14\active_projects\gb_schemes\herford\551497\herford relief road\07.0\drawing\currentwork\arsal\fige 2\dk_alignments & longsections.dwg

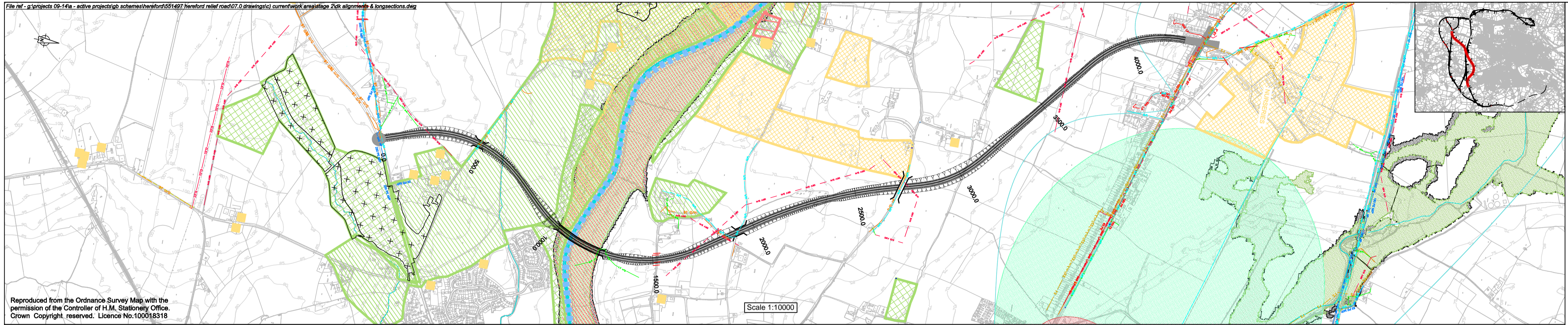

Reproduced from the Ordnance Survey Map with the permission of the Controller of H.M. Stationery Office. Crown Copyright reserved. Licence No.100016318

NOTES

- Historic Flood Map
- Area benefiting from flood defences
- Greater than 0.1% flood risk from river / sea (floodzone 2)
- Greater than 1.0% flood risk from river or 0.5% flood risk from sea (floodzone 3)
- Source Protection Zone 1 (river zone)
- Source Protection Zone 2 (water canal)
- Source Protection Zone 3 (pond/catchment)
- Flood defences
- Surface Water Course (with flow direction)
- Other designations
- Ancient Woodland
- Special Area of Conservation (SAC)
- Site of Special Scientific Interest (SSSI)
- Conservation Areas
- Special Wildlife Site (SWS)
- Archaeology
- Ancient Monument
- Historic Parks and Gardens
- LIP Proposed Housing Site
- Land Use (as shown)
- Listed building
- Roundabout
- Severance
- Bridge
- Culvert
- Proposed Traffic Signals

Rev	Revision details	Chkd	Appd	Date
A	Listed Buildings Added	SD	RM	21/09/10

Drawn: MG	Preliminary	<input checked="" type="checkbox"/>
Design: DK	For comment	<input type="checkbox"/>
Chkd: SD	For tender	<input type="checkbox"/>
Appd: RM	For construction	<input type="checkbox"/>
Date: Sept 2010	As constructed	<input type="checkbox"/>
	Other	<input type="checkbox"/>

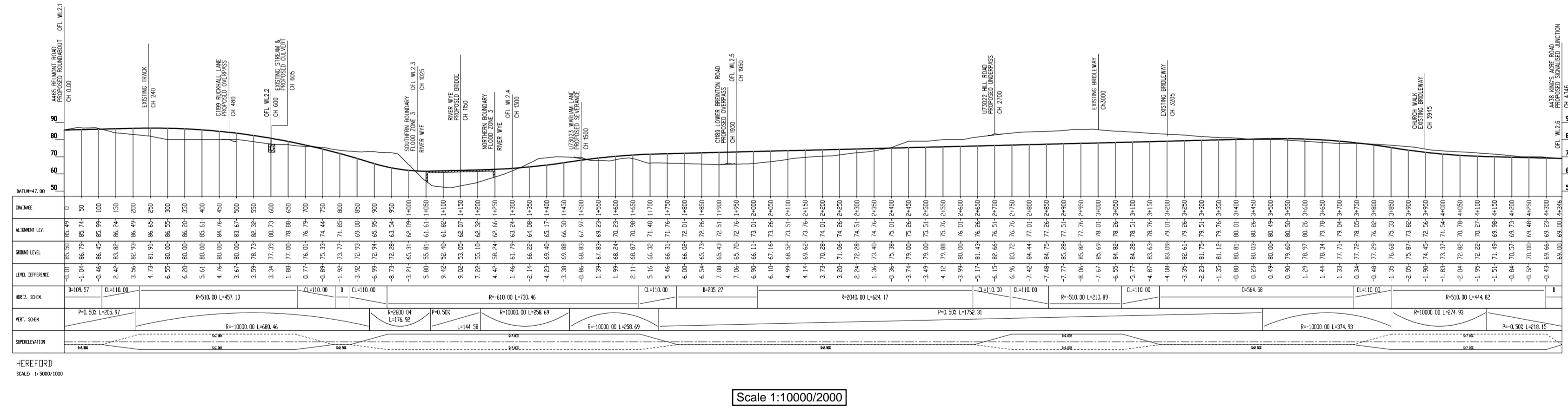

Scale 1:10000/2000



Client
M. HAINES
DIRECTOR OF ENVIRONMENT
& CULTURE

Herefordshire Council
Brockington, 35 Haberdashers, Hereford, HR1 1SH Tel: 01432 260760 Fax: 01432 261963

Project Name
Hereford Relief Road

Drawing Title
**Western Link 2
Sheet 4 of 32**

Original Drawing Size : A3
Scale : 1:10000 Dimensions : Metres

Drawing No 551497-H-P-A3.04	Map No A3.04	Rev A
--------------------------------	-----------------	----------