

Reproduced from the Ordnance Survey Map with the permission of the Controller of H.M. Stationery Office. Crown Copyright reserved. Licence No.100018318

Scale 1:10000

NOTES

- Historic flood map
 - Area benefiting from flood defences
 - Greater than 0.1% flood risk from river / sea (floodzone 2)
 - Greater than 1.0% flood risk from river or 0.5% flood risk from sea (floodzone 3)
 - Source Protection Zone 1 (inner zone)
 - Source Protection Zone 2 (outer zone)
 - Source Protection Zone 3 (total catchment)
 - Flood defences
 - Surface Water Course (with flow direction)
- Other designations
- Ancient Woodland
 - Special Area of Conservation (SAC)
 - Site of Special Scientific Interest (SSSI)
 - Conservation Areas
 - Special Wildlife Site (SWS)
 - Roundabout
 - Severance
- Archaeology
- Ancient Monument
 - Historic Parks and Gardens
 - UDP Proposed Housing Site
 - Land Use (as annotated)
 - Listed building
 - Bridge
 - Culvert
 - Proposed Traffic Signals
- E-ON 11kv PVC Cable
 - E-ON 66kv Overhead Cable
 - E-ON LV Overhead Cable
 - GAS - LHP Mains
 - GAS - LP Mains
 - GAS - MP Mains
 - BT Underground
 - WW - Combined Sewerage
 - WW - Existing Trunk Water Main
 - WW - Existing Water Main
 - WW - Foul Sewerage
 - WW - Pumped Foul Sewerage
 - BT Overhead

A	Listed Buildings Added	SD	RM	21/09/10
Rev	Revision details	Chkd	Appd	Date

Drawn: MG	Preliminary
Design: ID	For comment
Chkd: SD	For tender
Appd: RM	For construction
Date: Sept 2010	As constructed
	Other

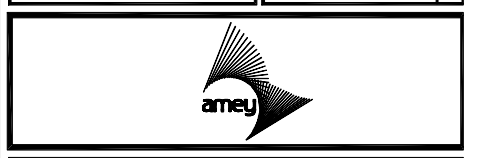

Client
M. HAINGE
 DIRECTOR of ENVIRONMENT & CULTURE
 Herefordshire Council
 Brockington, 35 Halold Road, Hereford, HR1 1SH Tel: (01432) 260780 Fax: (01432) 261983

Project Name
Hereford Relief Road

Drawing Title
Western Link 13
 Sheet 15 of 32

Original Drawing Size : A3
 Scale : 1:10,000 Dimensions : Metre

Drawing No	Map No	Rev
551497-H-P-A3.15	A3.15	A

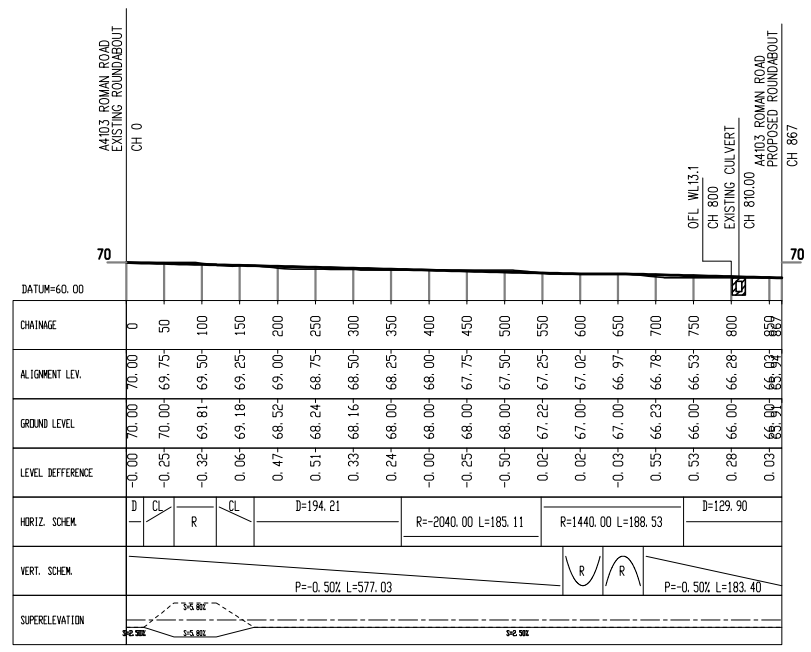

HEREFORD
 SCALE: 1:10,000/2,000

Scale 1:10000/2000