

Reproduced from the Ordnance Survey Map with the permission of the Controller of H.M. Stationery Office. Crown Copyright reserved. Licence No.100018318

NOTES

	Historic flood map		Ancient Monument
	Area benefiting from flood defences		Historic Parks and Gardens
	Greater than 0.1% flood risk from river / sea (floodzone 2)		UDP Proposed Housing Site
	Greater than 1.0% flood risk from river or 0.5% flood risk from sea (floodzone 3)		Land Use (as annotated)
	Source Protection Zone 1 (inner zone)		Listed building
	Source Protection Zone 2 (outer zone)		Bridge
	Source Protection Zone 3 (total catchment)		Culvert
	Flood defences		Proposed Traffic Signals
	Surface Water Course (with flow direction)		
	Ancient Woodland		
	Special Area of Conservation (SAC)		
	Site of Special Scientific Interest (SSSI)		
	Conservation Areas		
	Special Wildlife Site (SWS)		
	Roundabout		
	Severance		
	E-ON 11kv PVC Cable		WW - Combined Sewerage
	E-ON 66kv Overhead Cable		WW - Existing Trunk Water Main
	E-ON LV Overhead Cable		WW - Existing Water Main
	Gas - LHP Mains		WW - Foul Sewerage
	Gas - LP Mains		WW - Pumped Foul Sewerage
	Gas - MP Mains		
	BT Underground		
	BT Overhead		

A	Listed buildings added	SD	RM	21.09.10
Rev	Revision details	Chkd	Appd	Date

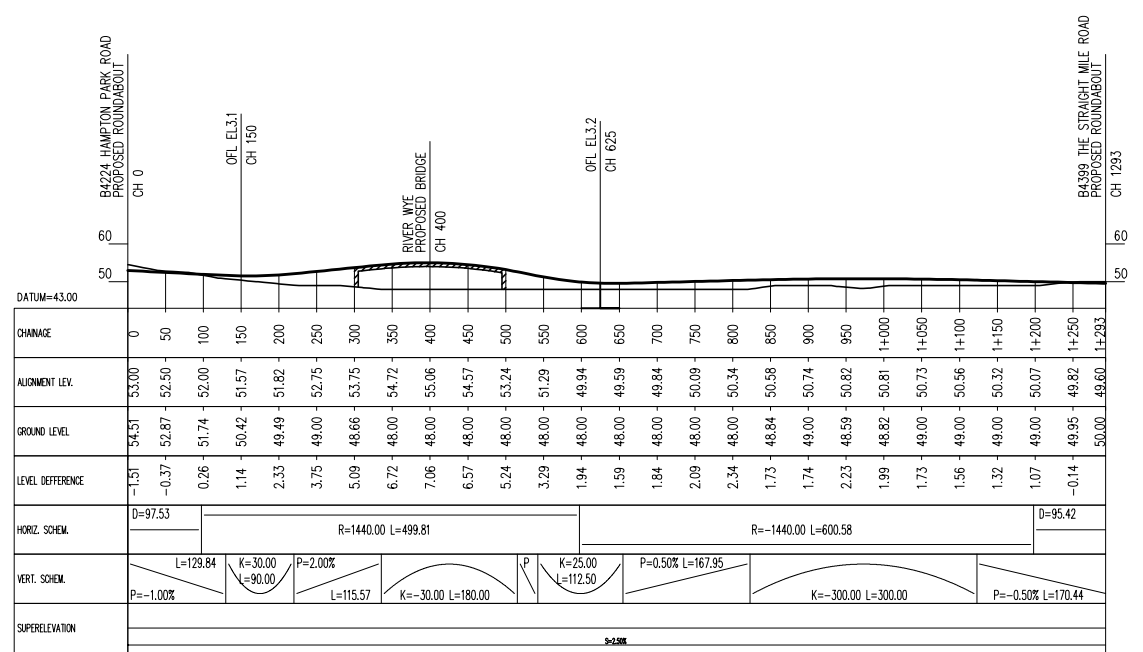

HEREFORD
SCALE: 1:5000/1000(A1), 1:10000/2000(A3)

Scale 1:10000/2000

Drawn: E.JL	Preliminary	<input checked="" type="checkbox"/>
Design: J.RP	For comment	<input checked="" type="checkbox"/>
Chkd: SD	For tender	<input type="checkbox"/>
Appd: RM	For construction	<input type="checkbox"/>
Date: June 2010	As constructed	<input type="checkbox"/>
	Other	<input type="checkbox"/>

Client
M. HAINGE
DIRECTOR of ENVIRONMENT & CULTURE

Brookington, 35 Hatford Road, Hereford, HR1 1SH Tel: (01432) 260780 Fax: (01432) 261983

Project Name
Hereford Relief Road

Drawing Title
**Eastern Link 3
Sheet 23 of 32**

Original Drawing Size : A3	Scale : As Shown	Dimensions : Metres
Drawing No 551497-H-P-A3.23	Map No A3.23	Rev A