

Inset Map 37

Sutton St Nicholas

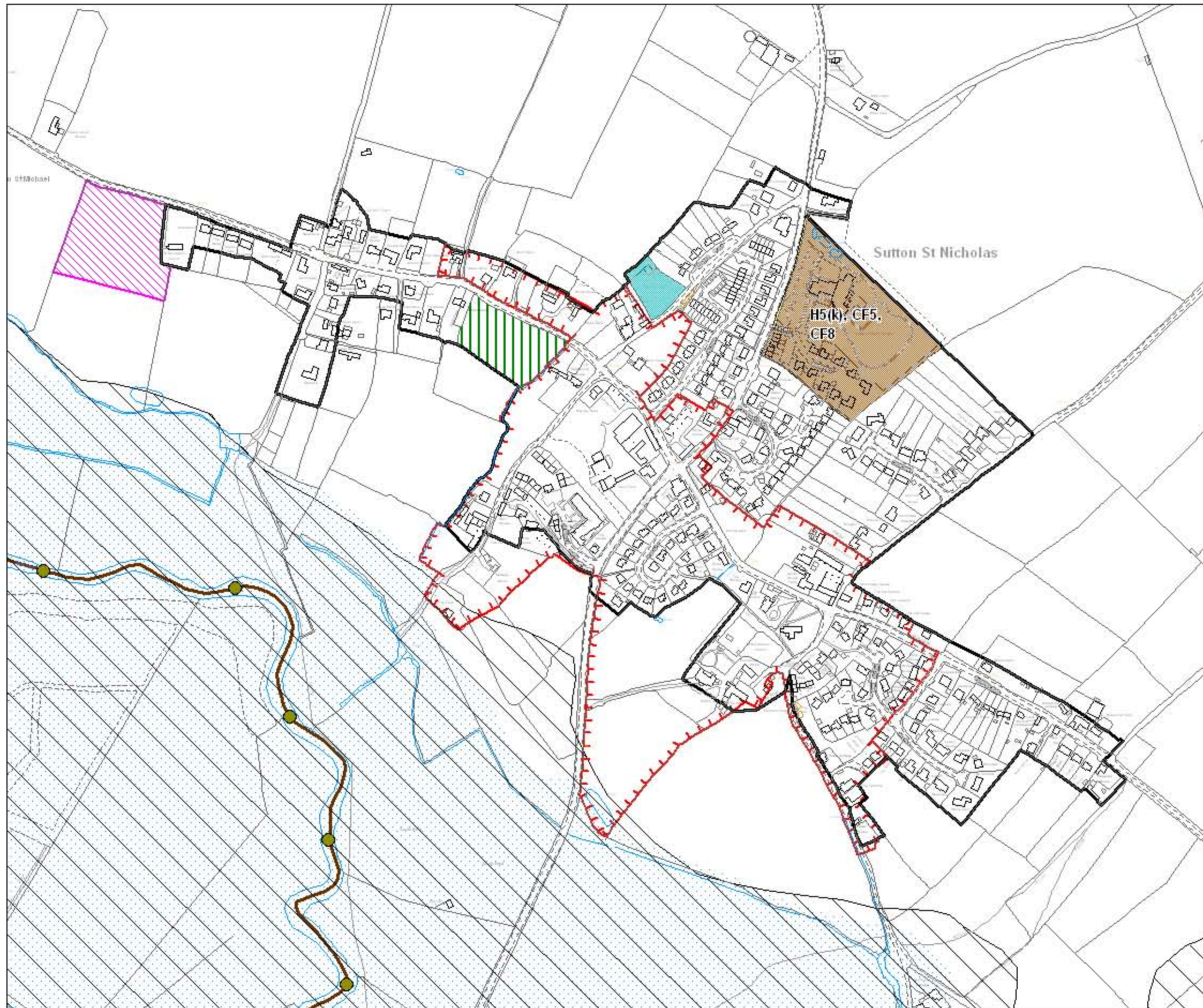

- Area Liable to Flood (DR7)
- Settlement Boundary (H4)
- Proposed Housing Site (H5)
- Safeguarding Mineral Reserves (M5)
- Site of Special Scientific Interest (SSSI) (NC3)
- Special Wildlife Site (SWS), Site of Interest for Nature Conservation, Section 39. (NC4)
- Conservation Area (HBA6)
- Protection of Open Areas and Green Spaces (HBA9)
- Scheduled Ancient Monument (SAM) (ARCH3)
- Safeguarding Open Space and Allotments (RST4)

The Written Statement contains general policies relating to the area covered by this map

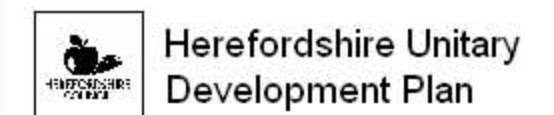

March 2007

Scale 1:5000
North

Reproduced from Ordnance Survey mapping with the permission of the Controller of Her Majesty's Stationery Office. Crown Copyright Unauthorised reproduction offences. Crown copyright and may lead to prosecution or civil proceedings. 100024168 2007