

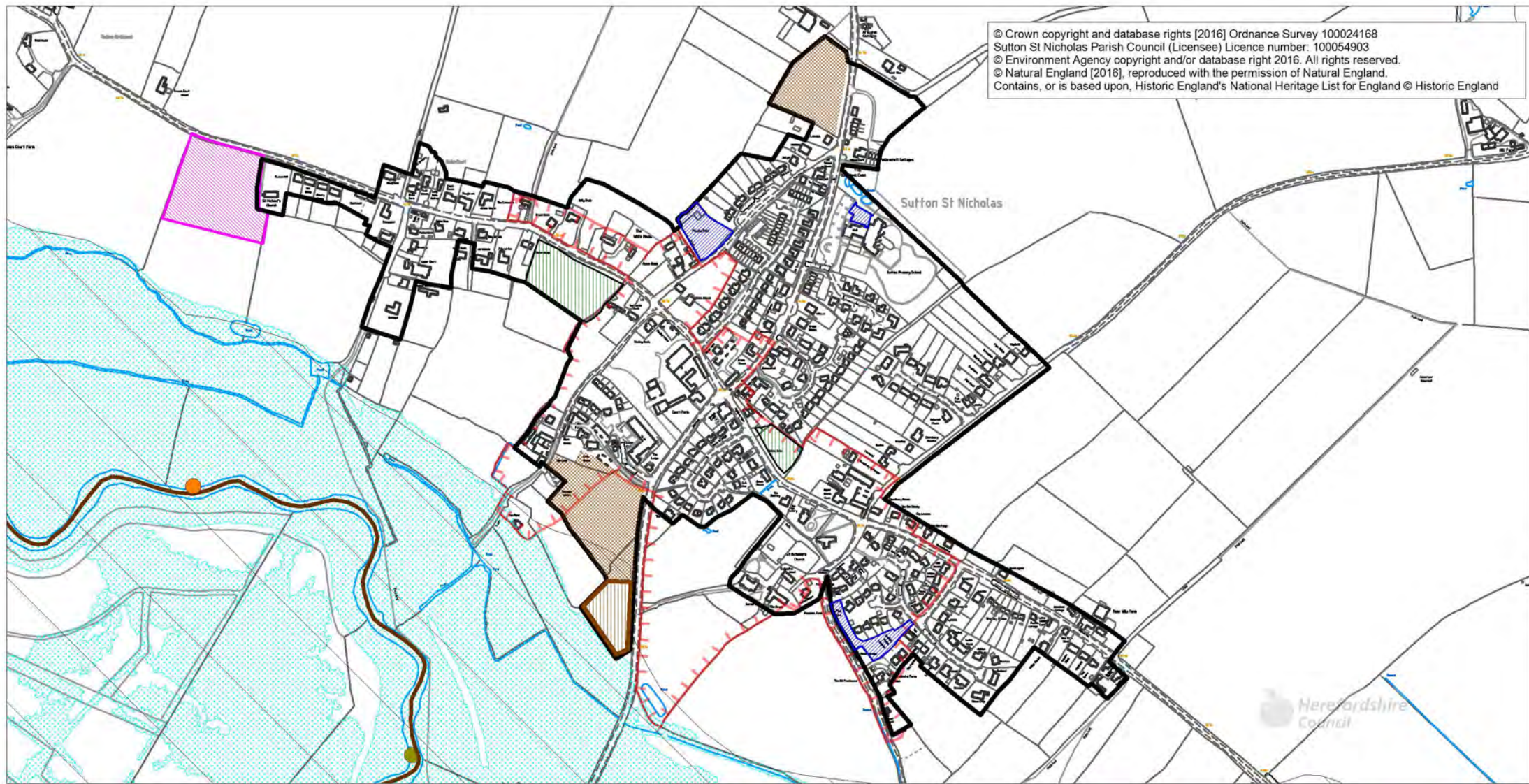







© Crown copyright and database rights [2016] Ordnance Survey 100024168
 Sutton St Nicholas Parish Council (Licensee) Licence number: 100054903
 © Environment Agency copyright and/or database right 2016. All rights reserved.
 © Natural England [2016], reproduced with the permission of Natural England.
 Contains, or is based upon, Historic England's National Heritage List for England © Historic England



- | | | | | | |
|--|---|---|---|---|-------------------------------------|
|  | Special Area for Conservation |  | Land to be kept free from development (Policy 3) |  | Protected Open Space (Policy 8) |
|  | Special Area for Conservation |  | Sutton St Nicholas Settlement Boundary (Policy 1) |  | Safeguarding Mineral Reserves |
|  | Land Liable to Flood |  | Local Green Space (Policy 8) |  | Site of Special Scientific Interest |
|  | Local Wildlife Site (LWS), Site of Importance for Nature Conservation |  | Scheduled Ancient Monuments |  | Site of Special Scientific Interest |
|  | Proposed Housing Site (Policies 2 & 3) |  | Conservation Area | | |

Sutton St Nicholas Village Policies Map